

Datasheet

Item no. 1302130

V1_0717_01_en

Product Description: Signal lamp, Φ 16mm, 12V.

BN: 1302130

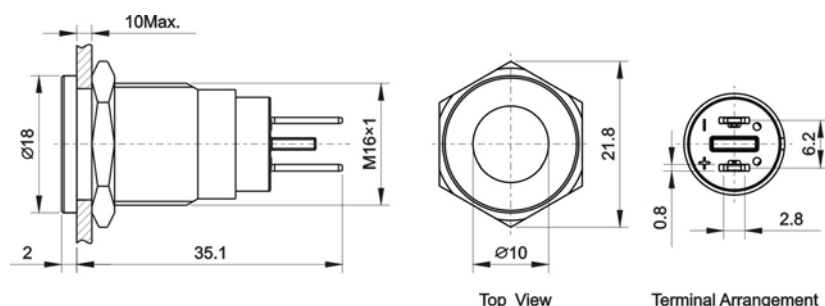

The Front Shape	Flat Round
Terminal Type	Pin Terminal(2.8x0.8mm)
Dielectric Intensity	2000VAC
Operating Temp	-20°C ~ +55°C
Humidity	45 ~ 85% RH
Panel Thickness	1~10mm
Rated Voltage	12V AC/ DC
Rated Current	15mA
LED Color	Blue
LED Life	40000 hours
Torque	5~14Nm
Lampshade Material.....	PC
Body Material	Nickel Plated Brass
Base Material	PBT

This is a publication by Conrad Electronic SE, Klaus-Conrad-Str. 1, D-92240 Hirschau (www.conrad.com).

All rights including translation reserved. Reproduction by any method, e.g. photocopy, microfilming, or the capture in electronic data processing systems require the prior written approval by the editor. Reprinting, also in part, is prohibited. This publication represents the technical status at the time of printing.

© Copyright 2017 by Conrad Electronic SE.