

IEC Appliance Outlet D, insert Mounting, Solder Terminal



Description

- 1 Function:
- Connector, Pin temperature 70 °C, Protection class II
- Solder terminal

Approvals

- VDE Certificate Number: 40011945
- UL File Number: E45115
- CSA File Number: 27324

Other versions on request

- For protection class II

Weblinks

[pdf-datasheet](#), [html-datasheet](#), [General Product Information](#), [Approvals](#), [CE declaration of conformity](#), [RoHS](#), [CHINA-RoHS](#), [REACH](#), [Mating Connectors](#), [e-Shop](#), [SCHURTER-Stock-Check](#), [Distributor-Stock-Check](#), [CAD-Drawings](#), [Accessories](#), [Wire Harnessing](#), [Detailed request for product](#)

Technical Data

Ratings IEC	2.5 A / 250 VAC; 50 Hz
Ratings UL/CSA	4 A / 250 VAC; 60 Hz
Dielectric Strength	> 4 kVAC between L-N > 2 kVAC between L/N-PE (1 min/50 Hz)
Allowable Operation Temp.	-25 °C to 70 °C
Degree of Protection	from front side IP 20 acc. to IEC 60529
Protection Class	Suitable for appliances with protection class II acc. to IEC 61140
Terminal	Solder terminal straight
Material: Housing	PA6, black or grey, UL 94V-0

Dimensions

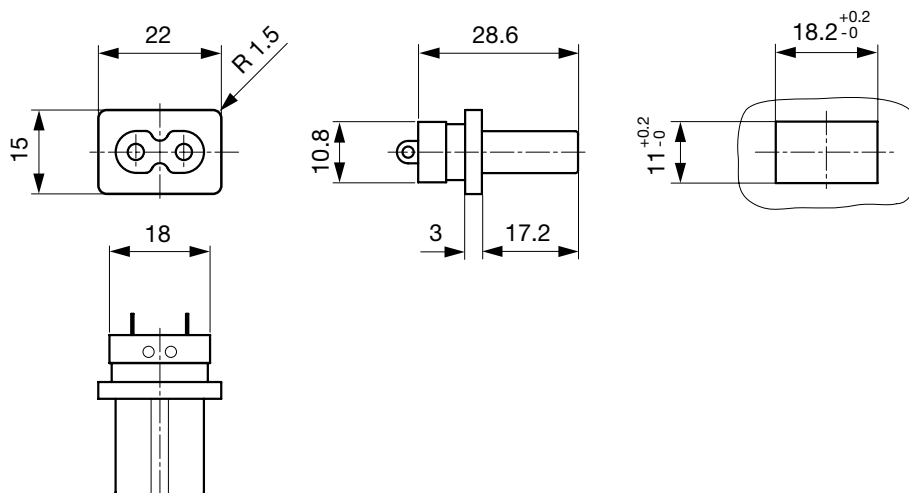

Length of the terminal please find at the order code configuration table

Config. Code

5086 - H - A B C 0 - D - E O

The characters are placeholders for the correspondingly keys of selections from the key tables.

5086 - H - A B C 0 - D - E O = Type

Type	Configuration key
protection class 2	X

5086 - H - A B C 0 - D - E O = Terminals

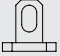
Terminal L	Configuration key
solder terminal 	1

5086 - H - A B C 0 - D - E O = Terminals

Terminal N	Configuration key
solder terminal	1

Symbols similar as in table A

5086 - H - A B C 0 - D - E O = Terminals

Terminal Ground	Configuration key
without terminal	0

Symbols similar as in table A

5086 - H - A B C 0 - D - E O = Color

Color	Configuration key
Black	A
Grey	B

5086 - H - A B C 0 - D - E O = Style

Style	Configuration key
insert type	5

5086 - H - A B C 0 - D - E O = Features

Features	Configuration key

All Variants

Config. Code	Description	Order Number
5086-X-1100-A-5	5086, IEC Connector , 70°C, version: II, L: solder terminal, N: solder terminal, ground: without terminal, color: Black, design: insert type, dimension X:	6180.0006

The listed variants should be available from stock Other versions on request www.schurter.com/contact

Availability for all products can be searched real-time: <http://www.schurter.com/en/Stock-Check/Stock-Check-SCHURTER>

Packaging unit 50 Pcs

Accessories

Description



[Wire Harness](#)
Wire harness for SCHURTER products

Mating Inlets/Plugs

Category / Description



[Power Entry Module with line filter Overview complete](#)

IEC Appliance Inlet C8 with Filter, Front Side Mounting

5008

[Power Entry Module with line filter further types to 5086](#)