

THIS DRAWING IS THE EXCLUSIVE PROPERTY OF MARQUARDT. WITHOUT THEIR CONSENT IT MAY NOT BE REPRODUCED OR GIVEN TO THIRD PARTIES.

CONFIDENTIAL

VERTRAULICH

Alle Rechte bei Marquardt, auch fuer den Fall von Schutzrechtsverletzungen. Jede Veruegungsbefugnis, wie Kopier- und Weitergaberecht, bei uns.

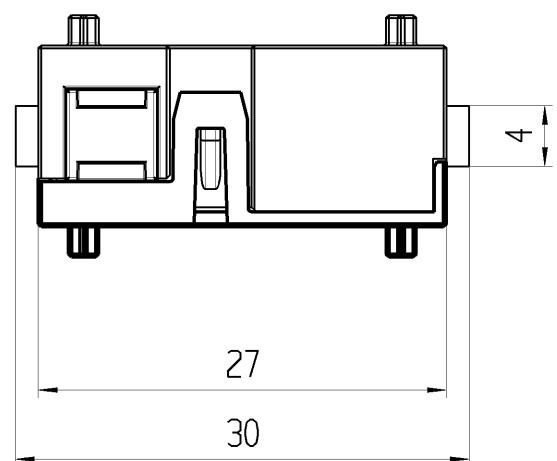
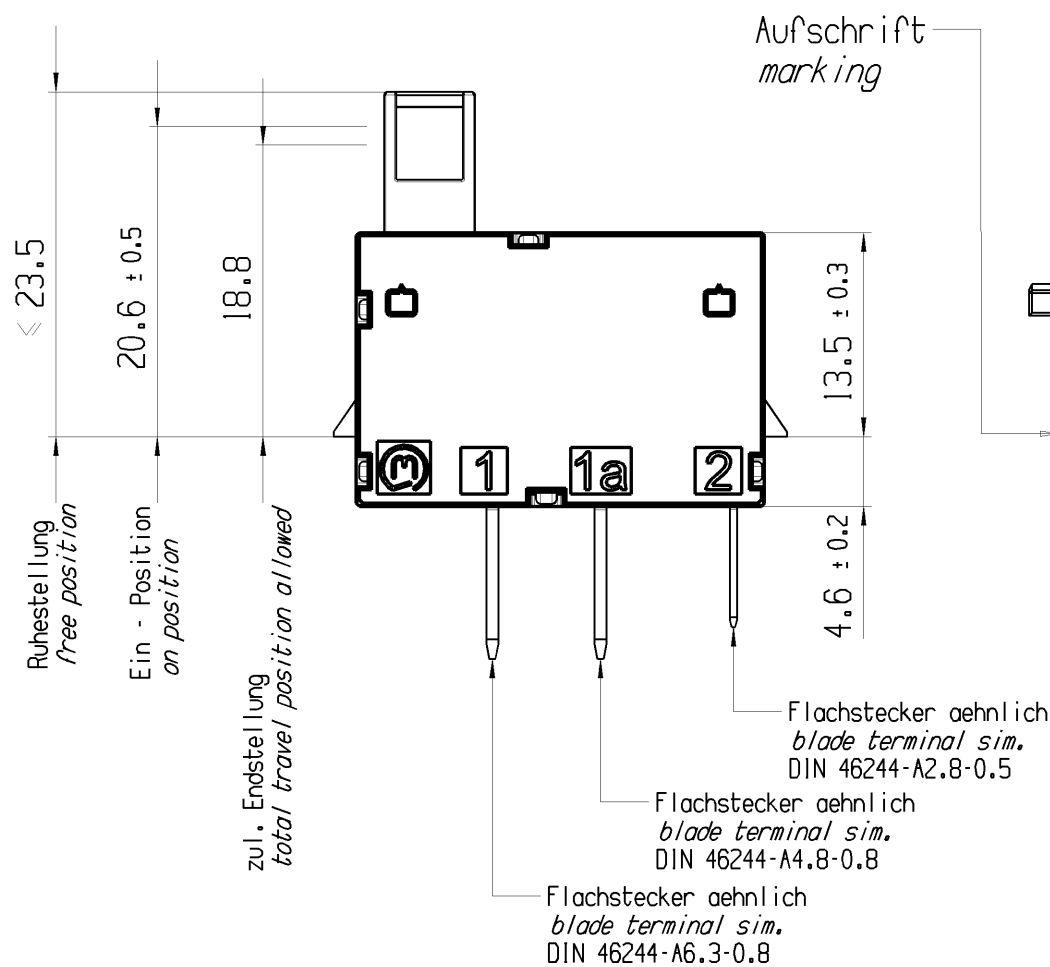
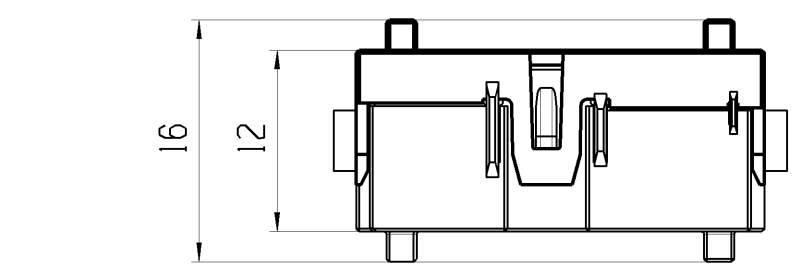

Betaetigungskraft  $F \leq 2.5 \text{ N}$   
 typical operating force

Aufschrift  
 marking

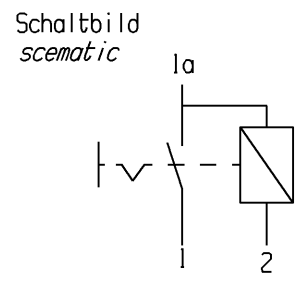
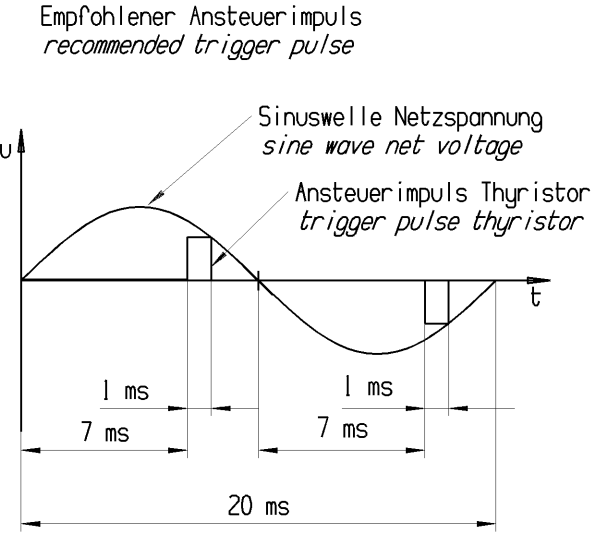

Aufschrift  
 marking  
 1086.  
 10131/250 ~ T85

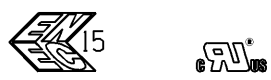

Herstellort/ -jahr/ -woche  
 data code of manufacture place/ year/ week

Lagerung in schwefelarmer Umgebung  
 storage in low-sulphur environment

G=Konform nach IEC 60335-1:2001 Kap.30  
 G=matching IEC 60335-1:2001 clause 30

Spulendaten data of coil	
Widerstand bei 20° C resistance at 20° C	68 $\Omega$ $\pm$ 10 %
Induktivitaet L bei 50 Hz Inductance L at 50 Hz	3.67 mH $\pm$ 10%
Spannung voltage	198 ... 253 VAC
Frequenz frequency	50 / 60 Hz
Stromstaerke I <sub>nominal</sub> Current I <sub>nominal</sub>	3.38 A
Stromstaerke I <sub>min</sub> Current I <sub>min</sub>	2.61 A
Stromstaerke I <sub>max</sub> current I <sub>max</sub>	4.14 A
max. Umgebungstemperatur max. ambient temperature	85° C
Impulsdauer impuls duration	10 ms $\pm$ 10%
Pausenzeit break duration	20 s $\pm$ 1 s

Ausschalter 1-polig  
 mit elektr. Abschaltung

SPST  
 with electrical switch off

fuer Form und Lage FOR SHAPE AND LOC.	fuer Winkel FOR ANGLE.	PROJEKTION	Allgemeintoleranzen UNTOLERANCED DIMENSIONS				Pause COPY	Blatt SHEET 01	TYP K	Zeichn./DRAWING NO. 10863101	Index g	
			Abmasse und Angaben in mm	Laenge LENGTH	Radien RADII	SCALE 2:1						
ALL DIMENSIONS ARE IN MILLIMETRES			0-6 $\pm$ 0.15	$\pm$ 0.2	$\pm$ 0.2	CAD: NX V6.0	Original Din A3	Mossstab SCALE 2:1	GERAETESCHALTER			
			>6-15 $\pm$ 0.2	$\pm$ 0.3	$\pm$ 0.5				gez./DRAWN BY 29.09.11 BRC gepr./CHECKED BY	Appliance switch		
			>15-30 $\pm$ 0.25	$\pm$ 0.5	$\pm$ 10%					Ersatz fuer/REPLACEMENT OF		
			>30-70 $\pm$ 0.4									
			>70-120 $\pm$ 0.6									
Ausg. ISSUE	Aenderung REVISION	gez. DRAWN BY	Ausg. ISSUE	Aenderung REVISION	gez. DRAWN BY							