

Data sheet | Item number: 786-101

Empty component plug housing; Type 14; 15 mm wide; 6-pole; gray

www.wago.com/786-101

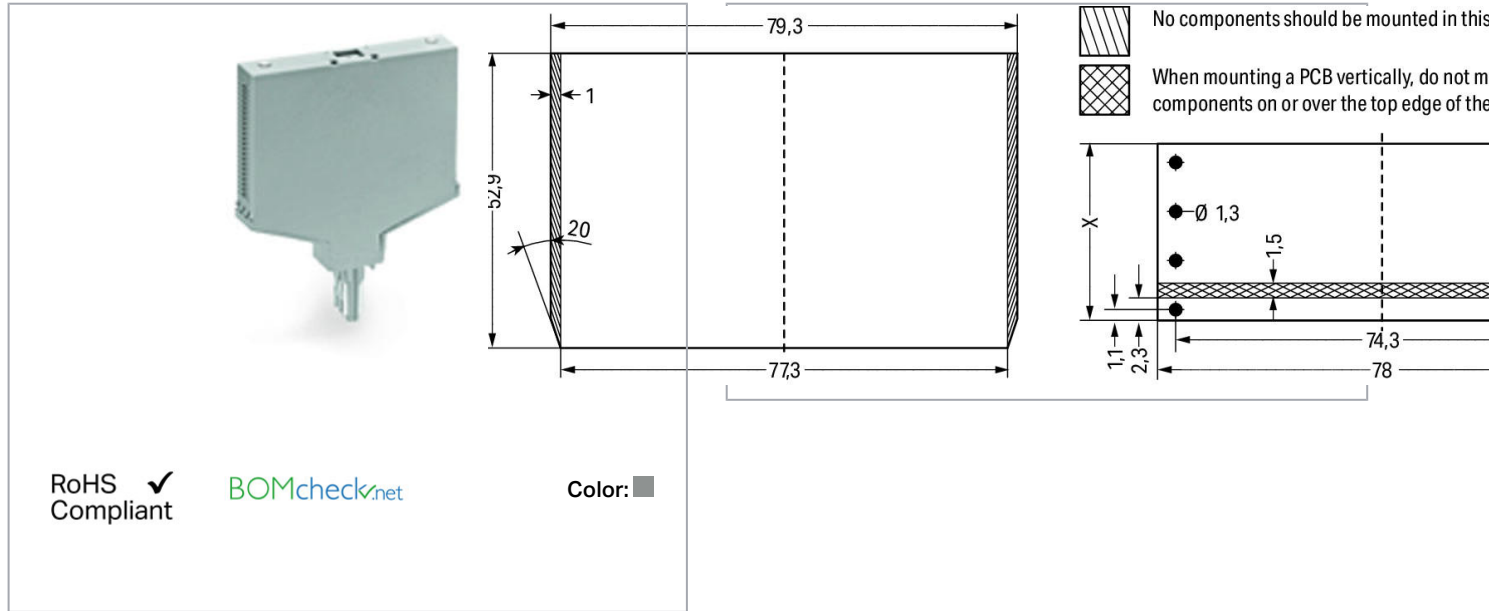

Width	15	20	25
Height	9.2	14.2	19.2
Height of PCB	13	18	23

Item description

Empty component plug housing, type 14

Data

Electrical data

Rated continuous current

6 A

Subject to changes. Please also observe the further product documentation!

WAGO Kontakttechnik GmbH & Co. KG
Hansastr. 27
32423 Minden
Phone: +49571 887-0 | Fax: +49571 887-169
Email: info.de@wago.com | Web: www.wago.com

Do you have any questions about our products?
We are always happy to take your call at +49 (571) 887-44222.

Safety and protection

Rated voltage	250 V
Rated surge voltage	4 kV
Pollution degree	3

Connection data

Pole No.	6
----------	---

Physical data

Width	15 mm / 0.591 inch
Height from upper-edge of DIN-rail	82.5 mm / 3.243 inch
Depth	84 mm / 3.307 inch

Mechanical data

Housing design	Plug for carrier terminal blocks
Mounting type	Pluggable module for receptacle terminal blocks

Material data

Color	gray
Fire load	0.748 MJ
Weight	30.8 g

Commercial data

Product Group	6 (Interface Electronics)
Packaging type	BOX
Country of origin	DE
GTIN	4050821082293
Customs tariff number	85366990990

Compatible products

Marking accessories



Item no.: 209-501
WSB marking card; as card; not stretchable; plain; snap-on type; white

www.wago.com/209-501



Item no.: 209-501/000-002
WSB marking card; as card; not stretchable; plain; snap-on type; yellow

www.wago.com/209-501/000-002

Subject to changes. Please also observe the further product documentation!



Item no.: 209-501/000-005
WSB marking card; as card; not stretchable; plain; snap-on type; red

www.wago.com/209-501/000-005



Item no.: 209-501/000-006
WSB marking card; as card; not stretchable; plain; snap-on type; blue

www.wago.com/209-501/000-006



Item no.: 209-501/000-007
WSB marking card; as card; not stretchable; plain; snap-on type; gray

www.wago.com/209-501/000-007



Item no.: 209-501/000-012
WSB marking card; as card; not stretchable; plain; snap-on type; orange

www.wago.com/209-501/000-012



Item no.: 209-501/000-017
WSB marking card; as card; not stretchable; plain; snap-on type; light green

www.wago.com/209-501/000-017



Item no.: 209-501/000-023
WSB marking card; as card; not stretchable; plain; snap-on type; green

www.wago.com/209-501/000-023



Item no.: 209-501/000-024
WSB marking card; as card; not stretchable; plain; snap-on type; violet

www.wago.com/209-501/000-024



Item no.: 209-701
WSB marking card; as card; not stretchable; plain; snap-on type; white

www.wago.com/209-701



Item no.: 209-701/000-002
WSB marking card; as card; not stretchable; plain; snap-on type; yellow

www.wago.com/209-701/000-002



Item no.: 209-701/000-005
WSB marking card; as card; not stretchable; plain; snap-on type; red

www.wago.com/209-701/000-005



Item no.: 209-701/000-006
WSB marking card; as card; not stretchable; plain; snap-on type; blue

www.wago.com/209-701/000-006



Item no.: 209-701/000-007
WSB marking card; as card; not stretchable; plain; snap-on type; gray

www.wago.com/209-701/000-007



Item no.: 209-701/000-012
WSB marking card; as card; not stretchable; plain; snap-on type; orange

www.wago.com/209-701/000-012

Subject to changes. Please also observe the further product documentation!



Item no.: 209-701/000-017

WSB marking card; as card; not stretchable; plain; snap-on type; light green

www.wago.com/209-701/000-017



Item no.: 209-701/000-023

WSB marking card; as card; not stretchable; plain; snap-on type; green

www.wago.com/209-701/000-023



Item no.: 209-701/000-024

WSB marking card; as card; not stretchable; plain; snap-on type; violet

www.wago.com/209-701/000-024

tools



Item no.: 210-492

Unlocking pliers for component plug housing

www.wago.com/210-492

General accessories



Item no.: 280-608

Terminal block for pluggable modules; 4-pole; with 4-conductor terminal blocks; with orange separator; www.wago.com/280-608 for DIN-rail 35 x 15 and 35 x 7.5; 2.5 mm²; CAGE CLAMP®; 2,50 mm²; gray



Item no.: 280-609

Terminal block for pluggable modules; 6-pole; with 4-conductor terminal blocks; with orange separator; www.wago.com/280-609 for DIN-rail 35 x 15 and 35 x 7.5; 2.5 mm²; CAGE CLAMP®; 2,50 mm²; gray



Item no.: 280-618

Terminal block for pluggable modules; 4-pole; with 2-conductor terminal blocks; with orange separator; www.wago.com/280-618 for DIN-rail 35 x 15 and 35 x 7.5; 2.5 mm²; CAGE CLAMP®; 2,50 mm²; gray



Item no.: 280-619

Terminal block for pluggable modules; 6-pole; with 2-conductor terminal blocks; with orange separator; www.wago.com/280-619 for DIN-rail 35 x 15 and 35 x 7.5; 2.5 mm²; CAGE CLAMP®; 2,50 mm²; gray



Item no.: 280-762

Terminal block for pluggable modules; 4-pole; with 4-conductor terminal blocks; with marker carrier; with orange separator; for DIN-rail 35 x 15 and 35 x 7.5; 2.5 mm²; CAGE CLAMP®; 2,50 mm²; gray

www.wago.com/280-762



Item no.: 280-763

Terminal block for pluggable modules; 6-pole; with 4-conductor terminal blocks; with marker carrier; with orange separator; for DIN-rail 35 x 15 and 35 x 7.5; 2.5 mm²; CAGE CLAMP®; 2,50 mm²; gray

www.wago.com/280-763

Downloads

Documentation

Additional Information

Disposal; Electrical and electronic equipment, Packaging

V 1.0.0

pdf
265.8 kB

Download

CAD/CAE-Data

CAD data

Subject to changes. Please also observe the further product documentation!

WAGO Kontakttechnik GmbH & Co. KG

Hansastr. 27

32423 Minden

Phone: +49571 887-0 | Fax: +49571 887-169

Email: info.de@wago.com | Web: www.wago.com

Do you have any questions about our products?

We are always happy to take your call at +49 (571) 887-44222.



2D/3D Models 786-101

[URL](#)

[Download](#)

CAE data

EPLAN Data Portal 786-101

[URL](#)

[Download](#)

ZUKEN Portal 786-101

[URL](#)

[Download](#)

WSCAD Universe 786-101

[URL](#)

[Download](#)

Environmental Product Compliance

Compliance Search

Environmental Product Compliance 786-101

[URL](#)

[Download](#)

Empty component plug housing; Type 14; 15 mm wide; 6-pole; gray

Installation Notes

Subject to changes. Please also observe the further product documentation!