

REVISIONS				
P.	LTN	DESCRIPTION	DATE	APP'D
A4		REVISED PER ECO-12-004531	06MAR2012	DLD DCS
A5		REVISED PER ECO-13-019501	12DEC2013	DD DS
A6		REVISED PER ECO-14-009938	02JUL2014	DD DS

- 1 ACCEPTS #4 SELF TAPPING THREAD FORMING SCREWS OR METRIC EQUIVALENT. DRIVE TO 0.4 N-m MINIMUM
- 2 DATE CODE IN THIS LOCATION USING 5 DIGIT CODE
FIRST 2 DIGITS = YEAR, SECOND 2 DIGITS = WEEK
LAST DIGIT = DAY.
- 3 MATERIALS: HEADER HOUSING - GLASS FILLED PBT
PINS - TIN OR GOLD PLATED BRASS
- 4 HOUSING COLORS ARE MECHANICALLY KEYED TO MATE ONLY WITH IDENTICALLY COLORED PLUG ASSEMBLIES.
- 5. HEADER MATES TO PLUG ASSEMBLY 776164 WHICH USES REELED TERMINAL 770520 OR LOOSE PIECE TERMINAL 770854

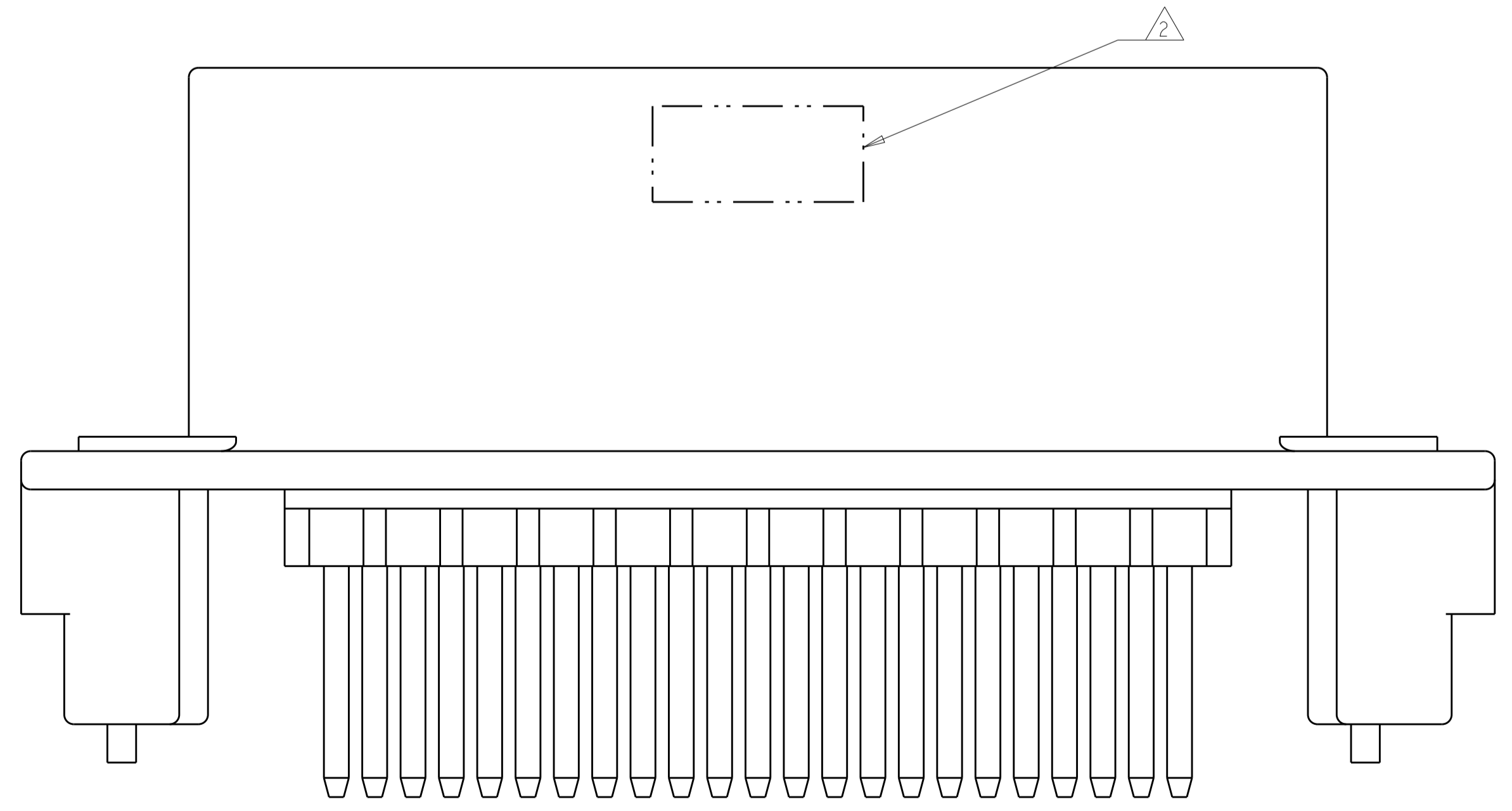
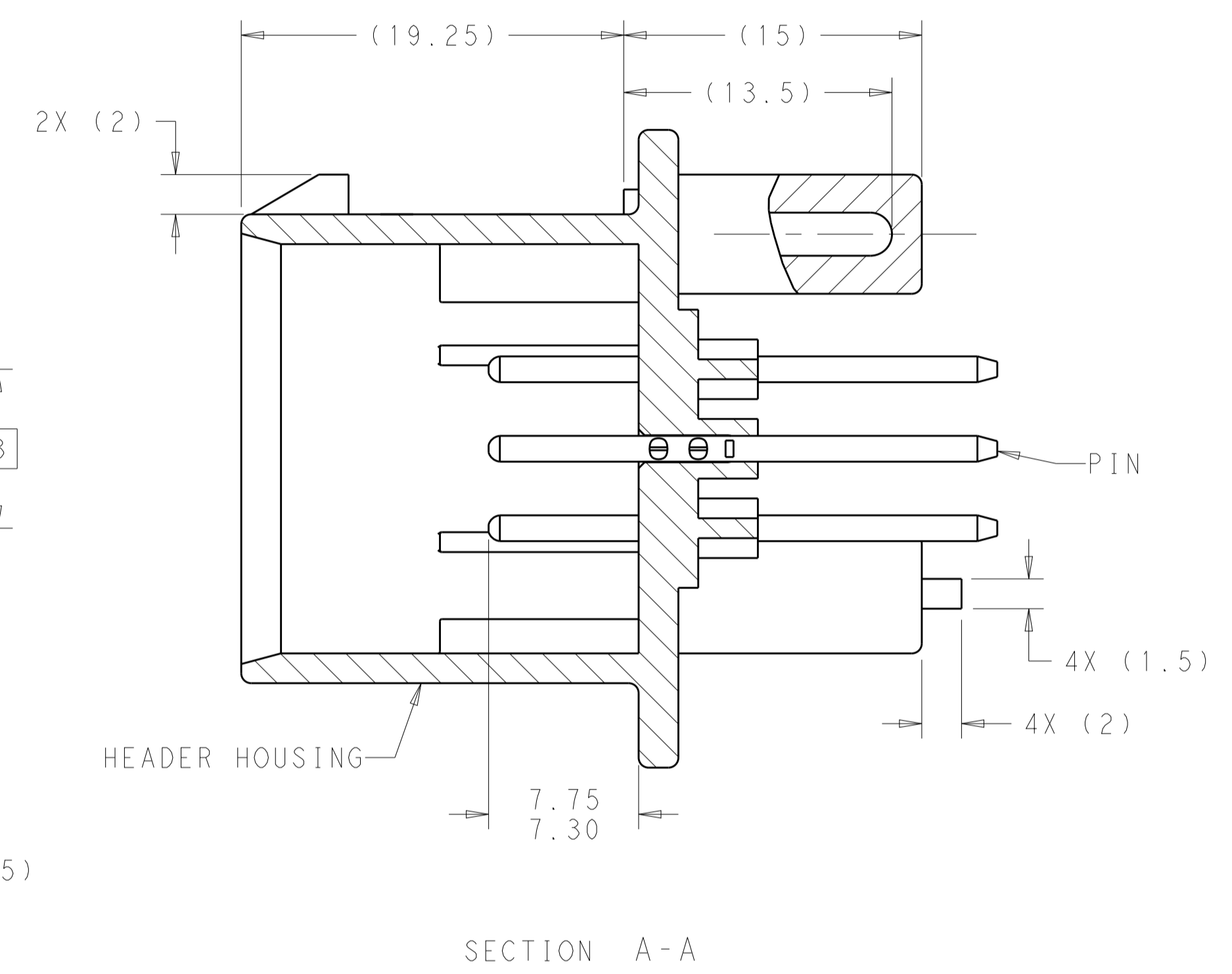
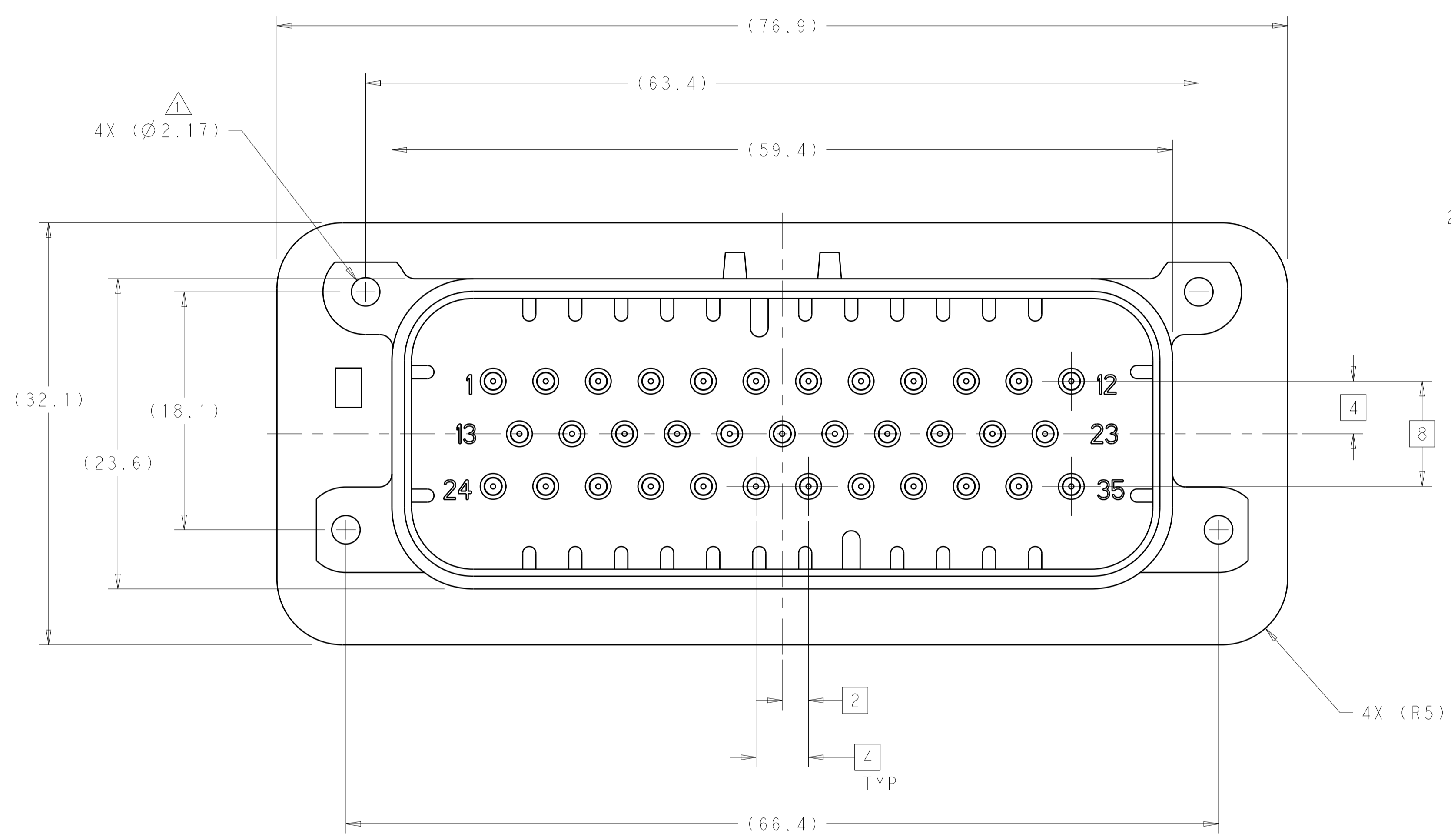

776230-1 & 1-776230-1 SHOWN

COLOR	MATERIAL	PART NUMBER
ORANGE	DURAGOLD	1-776230-6
BLUE	DURAGOLD	1-776230-5
GRAY	DURAGOLD	1-776230-4
NATURAL	DURAGOLD	1-776230-2
BLACK	DURAGOLD	1-776230-1
BLUE	TIN	776230-5
GRAY	TIN	776230-4
NATURAL	TIN	776230-2
BLACK	TIN	776230-1
HEADER COLOR	PLATING	PART NUMBER

THIS DRAWING IS A CONTROLLED DOCUMENT. DIMENSIONING AND TOLERANCING PER ASME Y14.5M-2009.

OWN: D. STRAUSSER 04FEB2010
 CHK: D. STRAUSSER 22MAR2010
 APVD: D. STRAUSSER 27APR2010

PRODUCT SPEC: 108-1329
 APPLICATION SPEC: 114-16016

MATERIAL: 3 FINISH: 4

SCALE: 4:1 SHEET 1 OF 2 REV: A6

ASSEMBLY, HEADER, 35 POSITION, VERTICAL, AMPSEAL

100779 776230

REVISIONS				
P.	LTN	DESCRIPTION	DATE	APVD
-	-	SEE SHEET 1	-	-

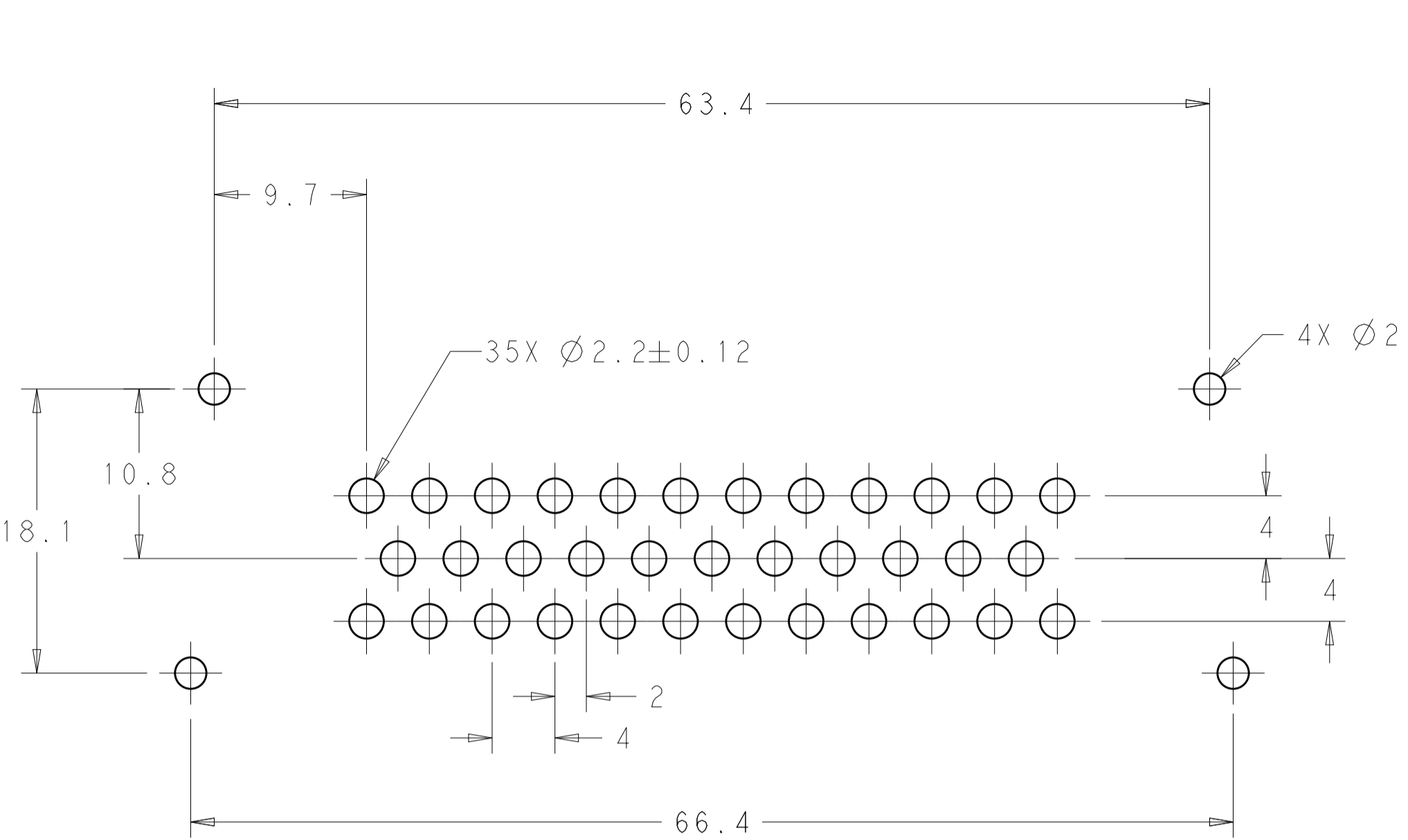

RECOMMENDED P.C. BOARD LAYOUT FOR 1.57 THICK P.C. BOARD

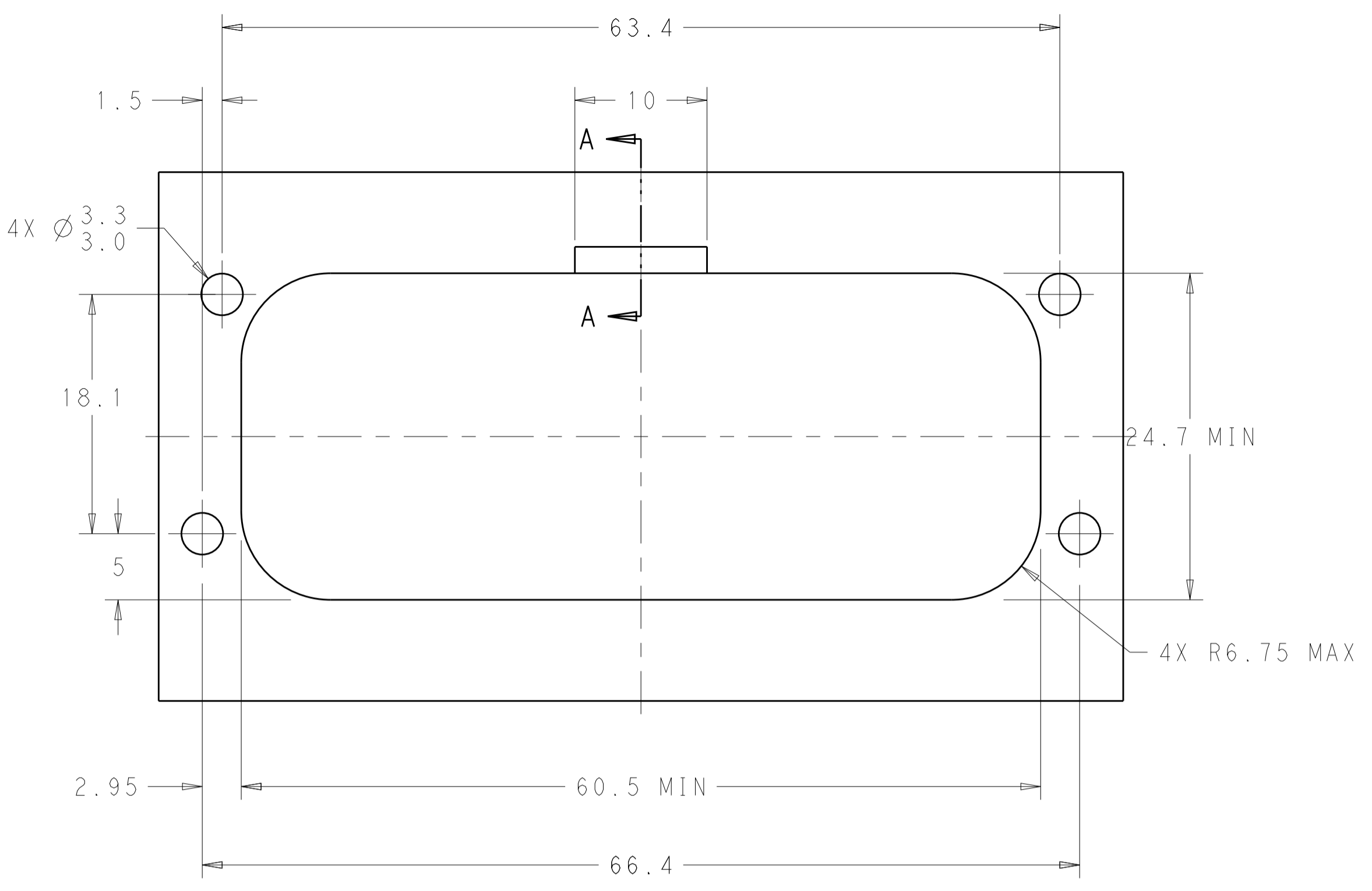

RECOMMENDED MOUNTING HOLE LAYOUT FOR 5.0 MAX THICK PANEL

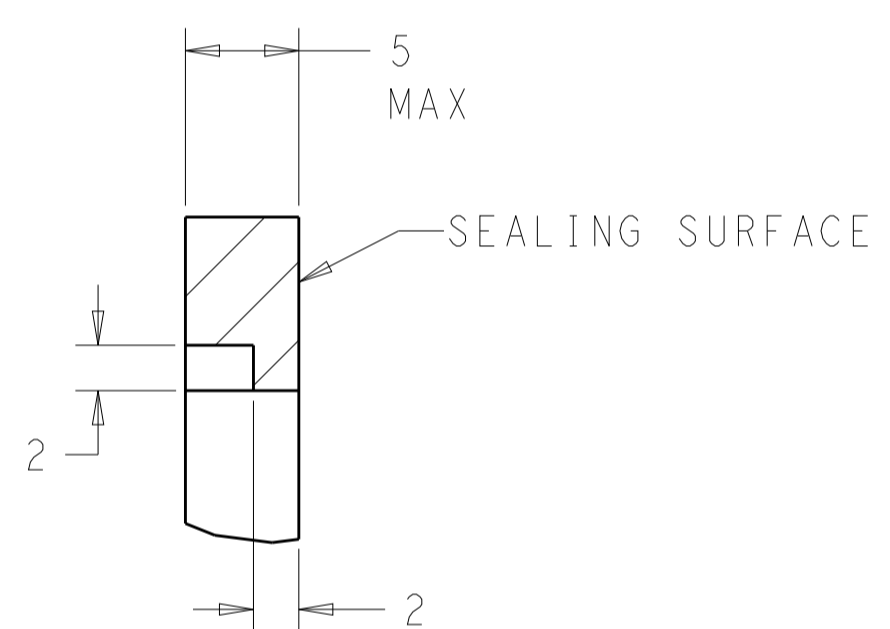

SECTION A-A
OPTIONAL CONSTRUCTION IF PANEL THICKNESS IS GREATER THAN 2.0

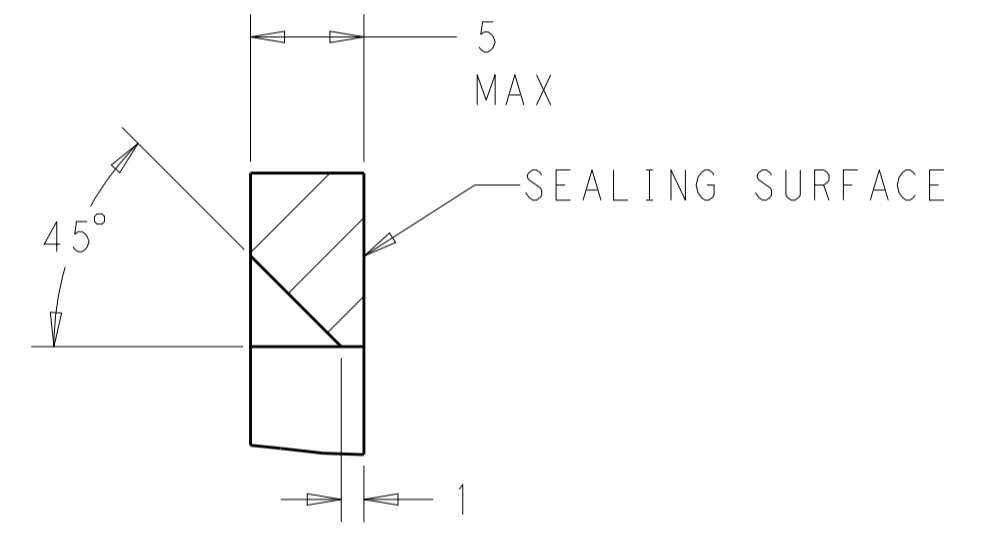

SECTION A-A
OPTIONAL CONSTRUCTION IF PANEL THICKNESS IS GREATER THAN 2.0

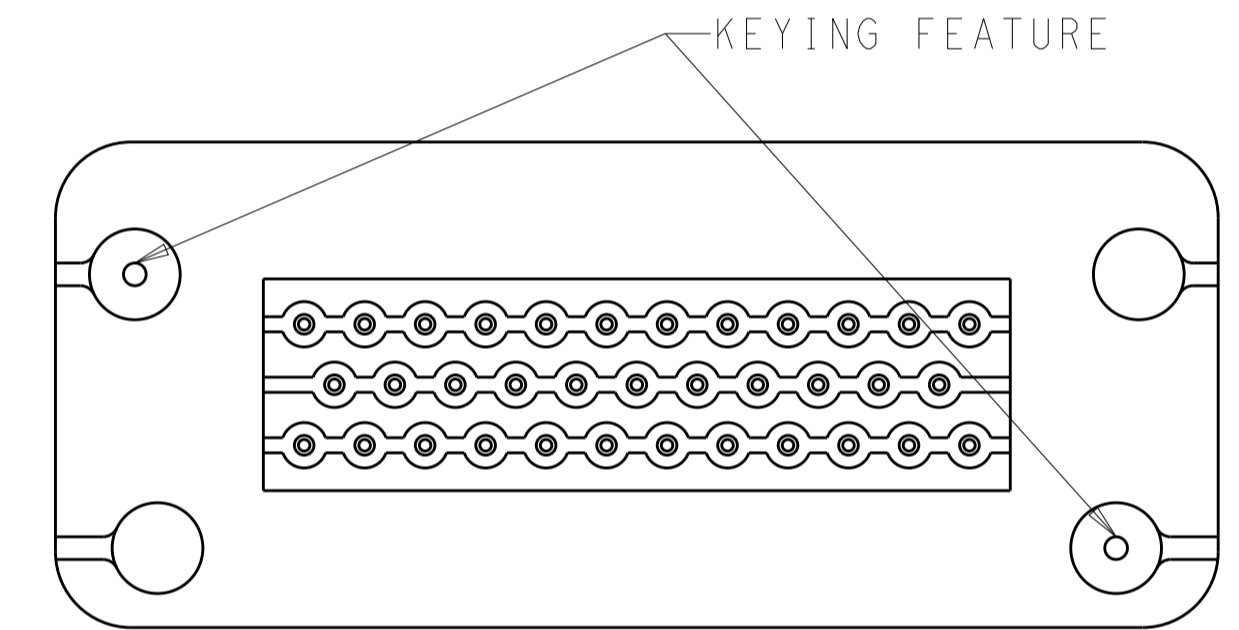

KEYING FOR 776230-1, 1-776230-1, 776230-4, 1-776230-4 AND 1-776230-6
SCALE 2:1

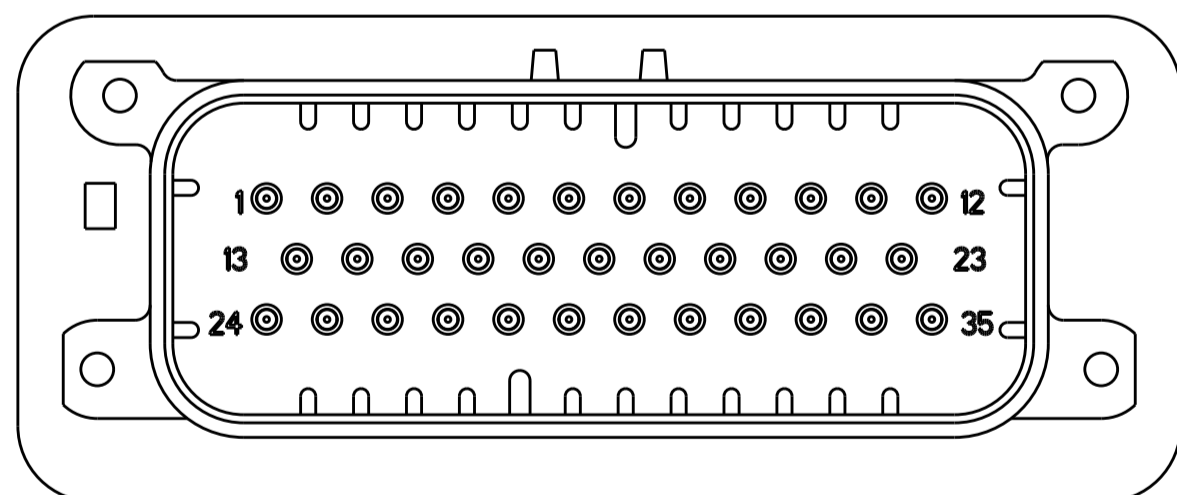

776230-2 & 1-776230-2
KEY LOCATION
SCALE 2:1

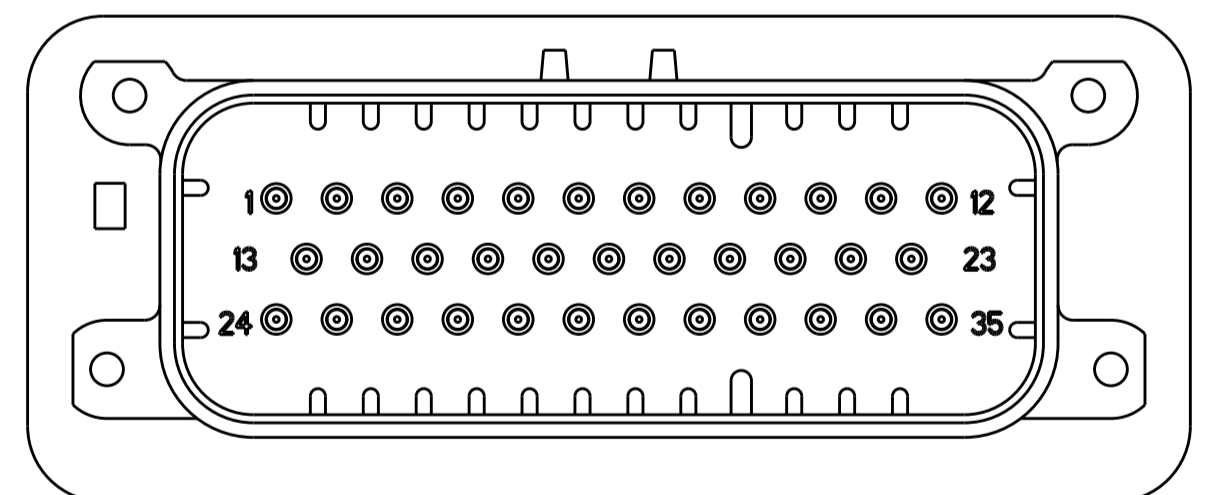

776230-4 & 1-776230-4
KEY LOCATION
SCALE 2:1

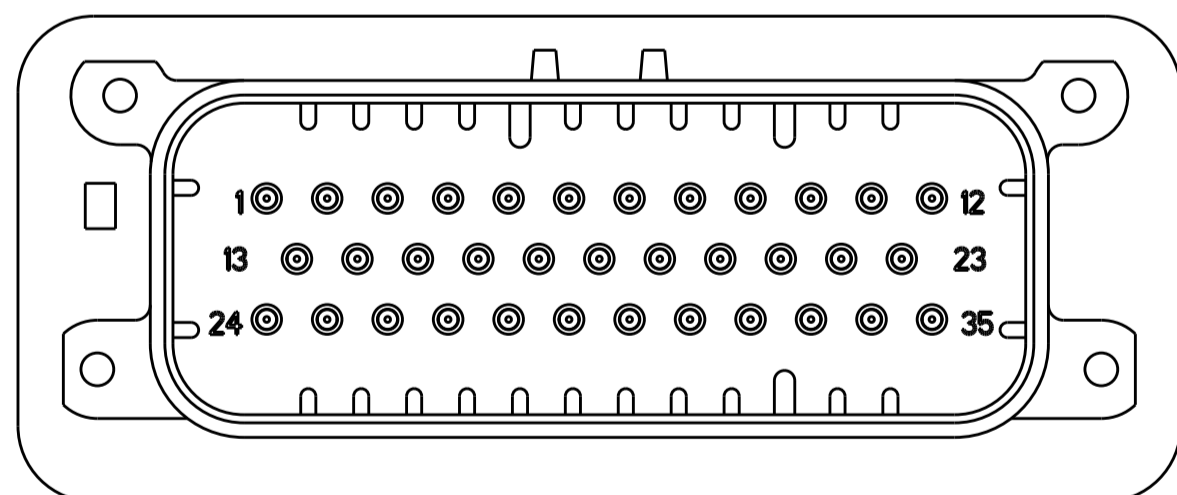

776230-5 & 1-776230-5
KEY LOCATION
SCALE 2:1

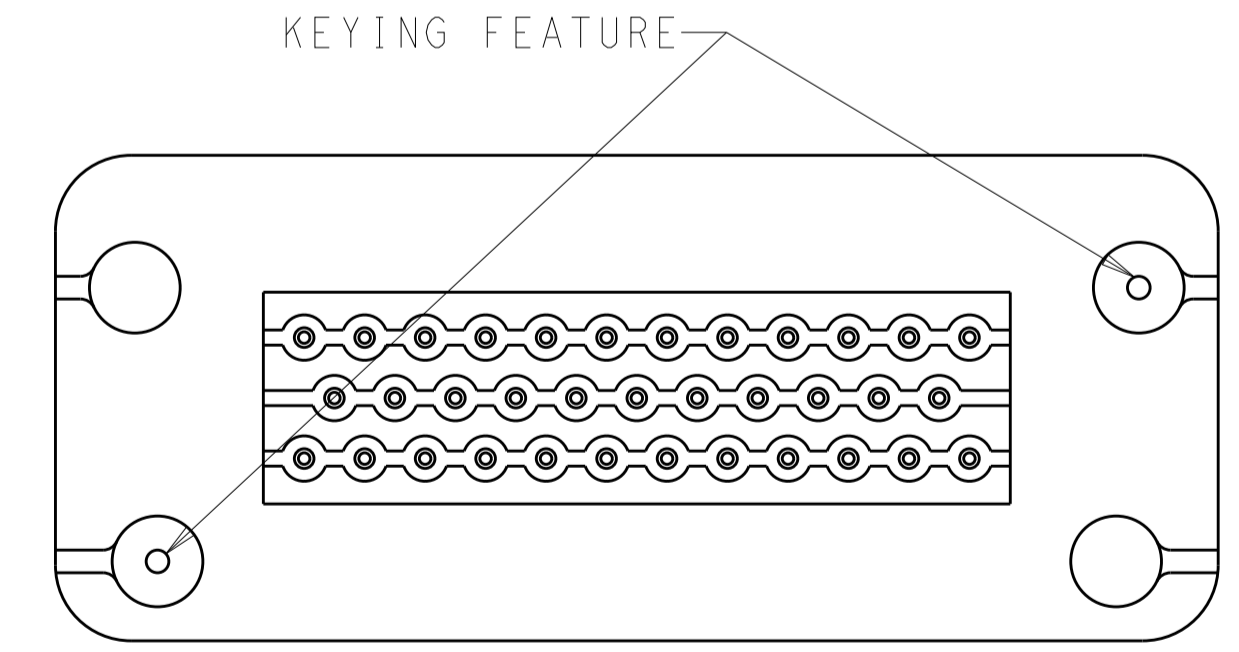

KEYING FOR 776230-2, 1-776230-2, 776230-5 AND 1-776230-5
SCALE 2:1

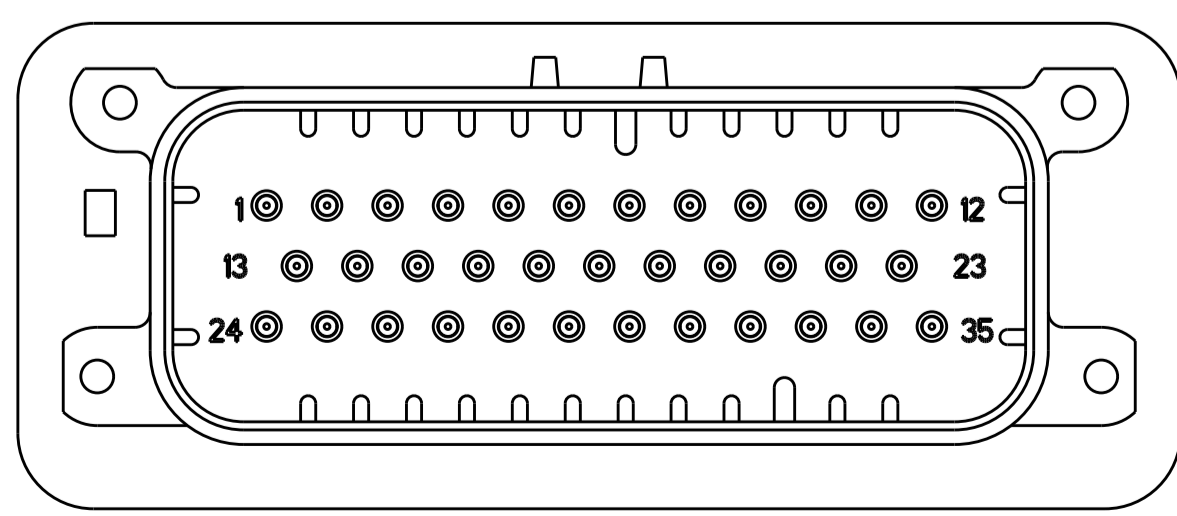

1-776230-6
KEY LOCATION
SCALE 2:1

THIS DRAWING IS A CONTROLLED DOCUMENT.		OWN: D. STRAUSSER 04FEB2010	TE Connectivity
DIMENSIONS: mm		CHK: D. STRAUSSER 22MAR2010	
TOLERANCES UNLESS OTHERWISE SPECIFIED:		APVD: D. STRAUSSER 27APR2010	NAME: ASSEMBLY, HEADER, 35 POSITION, VERTICAL, AMPSEAL
0 PLC ±	1 PLC ±0.2	PRODUCT SPEC: 108-1329	SIZE: CAGE CODE DRAWING NO: A100779C=776230
2 PLC ±0.13	3 PLC ±	APPLICATION SPEC: 114-16016	RESTRICTED TO: -
4 PLC ±	ANGLES ±°	WEIGHT: -	SCALE: 4:1 SHEET 2 OF 2 REV: A6
MATERIAL: -	FINISH: -	CUSTOMER DRAWING	