

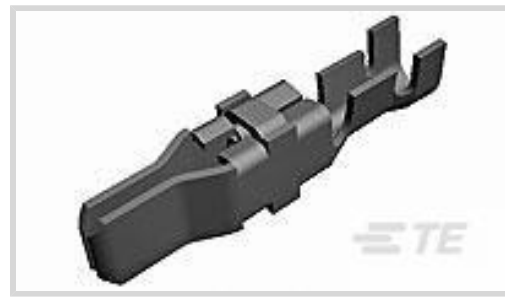

Connectors &gt; Power Connectors &gt; Power Contacts

Power Contact Type: **Contact**Contact Mating Area Plating Material: **Gold**Wire Size: **5 – 6 mm<sup>2</sup>**Connector & Contact Terminates To: **Wire & Cable**

## Features

### Product Type Features

Power Contact Type	Contact
Connector & Contact Terminates To	Wire & Cable

### Contact Features

Contact Mating Area Plating Material	Gold
Contact Current Rating (Max)	35 A
Contact Type	Tab
Mating Tab Width	5.84 mm[.23 in]
Mating Tab Thickness	2.67 mm[.105 in]
Contact Base Material	Copper
Contact Mating Area Plating Material Thickness	.76 μm[30 μin]
Wire Contact Termination Area Plating Thickness	.76 μm[30 μin]
Wire Contact Termination Area Plating Material	Gold
Wire Contact Termination Area Plating Material Finish	Bright
Contact Orientation	Right Angle
Contact Underplating Material	Copper

### Termination Features

Termination Method to Wire & Cable	Crimp
------------------------------------	-------

### Mechanical Attachment

Wire Insulation Support	With
-------------------------	------

### Dimensions

Wire Size	5 – 6 mm <sup>2</sup>
Compatible Insulation Diameter Range	4.83 – 5.59 mm [.19 – .22 in]

### Usage Conditions

Operating Temperature Range	-40 – 85 °C [-40 – 185 °F]
-----------------------------	----------------------------

### Operation/Application

Circuit Application	Power
---------------------	-------

### Packaging Features

Packaging Quantity	100
Packaging Method	Bag

### Other

Power Connectors Comment	Hand Tool No. 69710-1 uses Die Insert No. 90145-2 for 16 AWG and Die Insert No. 90145-1 for 14-12 AWG wire.
--------------------------	---

### Product Compliance

[For compliance documentation, visit the product page on TE.com>](#)

EU RoHS Directive 2011/65/EU	Compliant
EU ELV Directive 2000/53/EC	Compliant
China RoHS 2 Directive MIIT Order No 32, 2016	No Restricted Materials Above Threshold
EU REACH Regulation (EC) No. 1907/2006	Current ECHA Candidate List: JUNE 2023 (235) Candidate List Declared Against: JAN 2023 (233) Does not contain REACH SVHC
Halogen Content	BFR/CFR/PVC Free, but Br/Cl >900 ppm in other sources.
Solder Process Capability	Not applicable for solder process capability

#### Product Compliance Disclaimer

This information is provided based on reasonable inquiry of our suppliers and represents our current actual knowledge based on the information they provided. This information is subject to change. The part numbers that TE has identified as EU RoHS compliant have a maximum concentration of 0.1% by weight in homogenous materials for lead, hexavalent chromium, mercury, PBB, PBDE, DBP, BBP, DEHP, DIBP, and 0.01% for cadmium, or qualify for an exemption to these limits as defined in the Annexes of Directive 2011/65/EU (RoHS2). Finished electrical and electronic equipment products will be CE marked as required by Directive 2011/65/EU. Components may not be CE marked. Additionally, the part numbers that TE has identified as EU ELV compliant have a maximum concentration of 0.1% by weight in homogenous materials for lead, hexavalent chromium, and mercury, and 0.01% for cadmium, or qualify for an exemption to these limits as defined in the Annexes of Directive 2000/53/EC (ELV). Regarding the REACH Regulation, the information TE provides

on SVHC in articles for this part number is based on the latest European Chemicals Agency (ECHA) 'Guidance on requirements for substances in articles' posted at this URL: <https://echa.europa.eu/guidance-documents/guidance-on-reach>

## Compatible Parts

TE Part # 69710-1  
C-HEAD FRAME W/O DIES

TE Part # 7-1579008-6  
UNLOCKING TOOL

TE Part # 66741-6  
TYPE XII FEMALE CONT (L.P.)

TE Part # 206037-2  
CPC PLUG ASSEMBLY SIZE 17-3

TE Part # 90384-1  
HHHT TYPE XII MALE FEMALE 10 ASSY

TE Part # 356304-1  
TOOL HOLDER ASSY, STRHT ACTION

TE Part # 90140-1  
TYPE XII MALE FEMALE 10 DIE SET

## Customers Also Bought

TE Part #206425-2  
RECEPT ASSY,SZ 17-3,CPC

TE Part #2-1623728-6  
BCHE 11 W 680R 5%

TE Part #66260-2  
MALE CONTACT ASSY. (L.P.)

TE Part #8-1879627-9  
H4P 47K 1% 100PPM

TE Part #208482-1  
CMC PLUG ASSEMBLY,SZ 28

TE Part #814727-000  
222A132-4/42-0

TE Part #203618-1  
MALE J.S. ASSY. - SHORT

TE Part #1-640719-0  
02P UMNL STR/REL & INSRT NATL

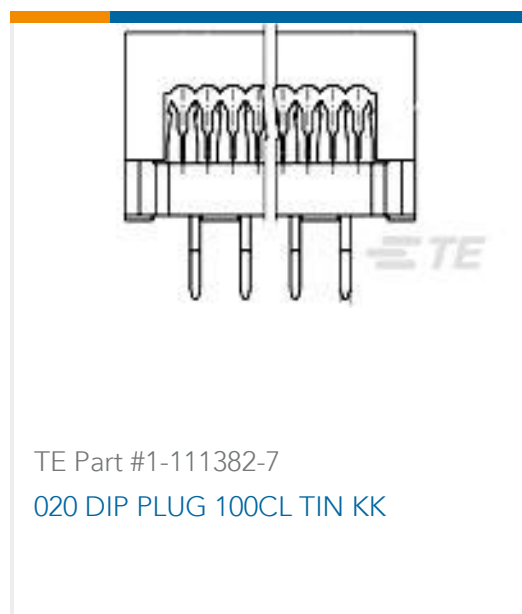

## Documents

### Product Drawings

#### MALE CONTACT ASSY. (L.P.)

English

### CAD Files

#### Customer View Model

[ENG\\_CVM\\_66259-2\\_Z.3d\\_igs.zip](#)

English

#### Customer View Model

[ENG\\_CVM\\_66259-2\\_Z.3d\\_stp.zip](#)

English

#### Customer View Model

[ENG\\_CVM\\_66259-2\\_Z.2d\\_dxf.zip](#)

English

### 3D PDF

English

By downloading the CAD file I accept and agree to the [Terms and Conditions](#) of use.

### Datasheets & Catalog Pages

#### AMP Circular Connectors for Commercial Signal & Power Applications

English

#### Power Contacts

English

#### M\_SERIES\_PIN\_AND\_SOCKET\_CONNECTORS

English

#### Products for Aerospace and Defense

English

### Product Specifications

#### Application Specification

English

### Instruction Sheets

#### Instruction Sheet (U.S.)

English

66259-2

Power Contacts, Contact, Gold, 10 AWG Wire Size, 5 – 6 mm<sup>2</sup> Wire Size, Wire & Cable, Crimp, Power, Tab, -40 – 85 °C [-40 – 185 °F]

