

23A

**TECHNICAL SPECIFICATION
FOR
ALKALINE MANGANESE BATTERY**

APPROVED BY:

DATE: January 3, 2002

SPEC.NO.: REF----R23----0102

1.Other name for the same type

L1028 23L VR22

2.Chemical SystemAlkaline Zinc—Manganese battery (+) Zn | KOH | MnO₂ (-)**3.Nominal Voltage:** 12V**4.Average Weight:** 8.06g**5.Nominal Capacity:** 57mAh

(continuous discharge at 20±2 under 0.10mA discharge current to 7.2V voltage)

6.Appearance : Metal Can**7.Electrical Characteristics:**

7.1 Off—load Voltage:

New Battery 12.10V

After 12 Months (Room Temp.) 12.00V

7.2 Discharge Time(continuous discharge at 20±2 under 20K discharge load
to 7.2V voltage)

New Battery 95 hours

After 12 Months (Room Temp.) 85 hours

7.3 Over—discharge Characteristic

Condition: 20K continuous discharge at 20±2 &65±20% R.H.

Period: 48hours

Characteristic: No deformation is over 0.20mm of the nominal dimension,
and no visual electrolyte leakage

8. Dimensions:

Nominal Dimension: $\phi 10.30 \times 28.80$

(Unit: mm)

Dimension	Range
A(ref.)	0.80
B	28.40 ± 0.30
C	10.05 ± 0.15
D(ref.)	0.20

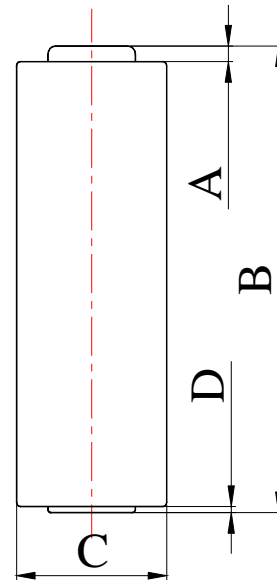

9. Typical Discharge Characteristics

(continuous discharge at 20 ± 2 under 20K discharge load to 7.2V voltage)

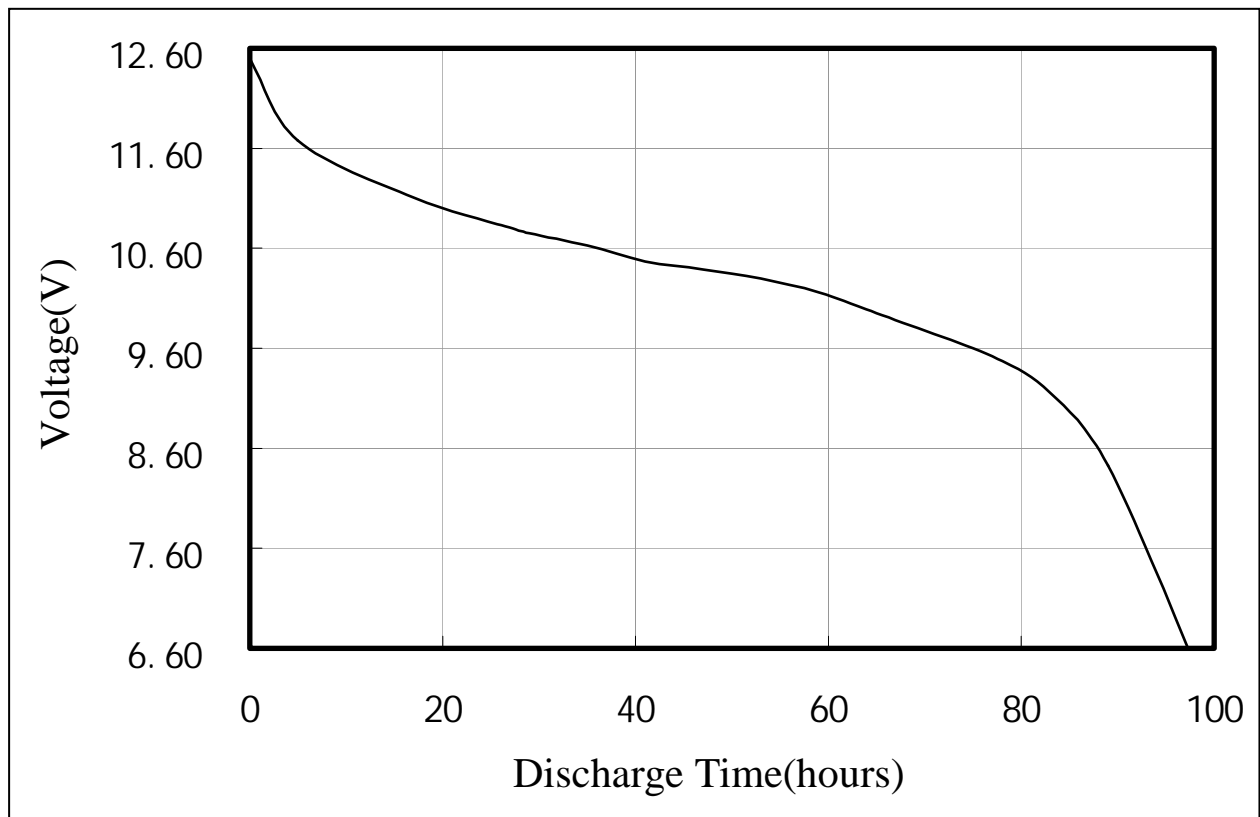

10. Mark:

The following message will be printed or stamped on the body of the battery:

10.1 Designation: 23A、 L1028 etc.

10.2 Manufacturer's name:

10.3 Trademark: DPOWER.

10.4 Nominal Voltage: 12V.

10.5: Pole: “+” and “-”.

10.6 Warning: May explode or leak if charged or disposed of in fire.

11. Caution for use :

11.1 There are risks of electrolyte leakage or causing damage to the device if the battery is charged;

11.2 The battery shall be installed with “+”and “-” in correct position;

11.3 Short-circuiting and heating the battery、 disposing of the can must not be permitted.

—————END—————