

SECTION: A-A

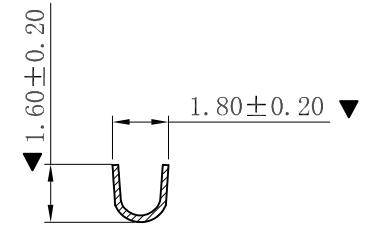

SECTION: B-B



SECTION: C-C

■ SPECIFICATIONS

- Voltage rating: 250V AC, DC
- Current rating: 5A, AC, DC
- Withstanding Voltage: 1500V AC/minute
- Temperature range: -25° C~+85° C
- Contact resistance: 20mΩ max

■ TERMINAL

- Applicable wire: AWG#22-#26
- Material: Phosphor Bronze
- Finish: Tin-Plated
- The Dimension Marked “▼” Must Be Recorded

745-7 0 - T M000R
 1 2 3

- 1. 7: Green Product
- 9: Green Product High Temp
- 2. T: Tin plated
- 3. Pinrex internal code.



				TOLERANCE		OLD PART NO.		TITLE	
				.0 =±.30		DRAWER 袁丽娜		Molex 2.54mm Male Terminal Connector Series	
				.00 =±.20		CHECK 李劍		PINREX TECHNOLOGY CORP.	
				.000 =±.XXX		APP'D 李劍		NEW PART NO. 745-70-TM000R	
A RELEASE		2020/06/15		SCALE NONE		SHEET 1 OF 1		DRAW NO. 745-70-TM000R	
REV. DESCRIPTION		DATE		SIZE A4		REV. A			
				ANG.=±3'					