

### MATERIAL

Insulator : NY6T UL94-V0

Contact Pin : Brass

### Specifications

Current Rating: 3Amp

Insulation Resistance: 1000MΩ Min.

Dielectric Withstanding: 600V AC/DC

Contact Resistance: 20mΩ Max.

Operating Temperature: -40°C to +105°C

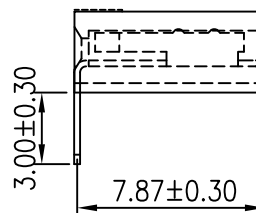
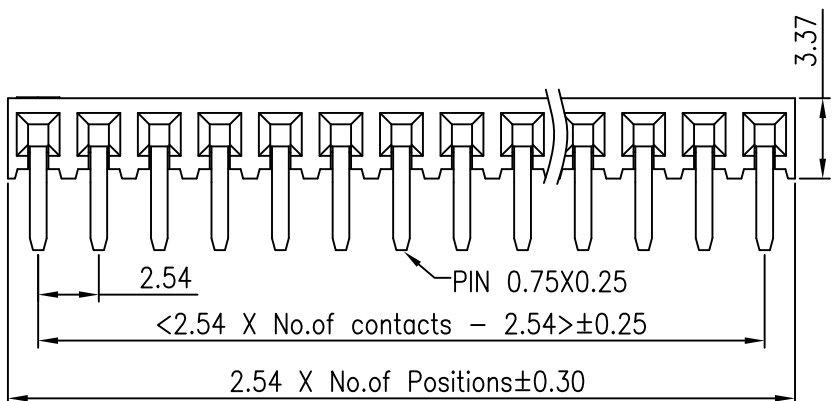

61B-9 1- xx G B 1R  
 1 2 3 4 5 6

1. 7: Green Product  
 9: Green Product High Temp
2. 1: Single row  
 2: Dual rows
3. No. of contacts per row
4. G: Gold flash  
 T: Tin plated
5. B: Black Insulator  
 W: White Insulator
6. Pinrex internal code.

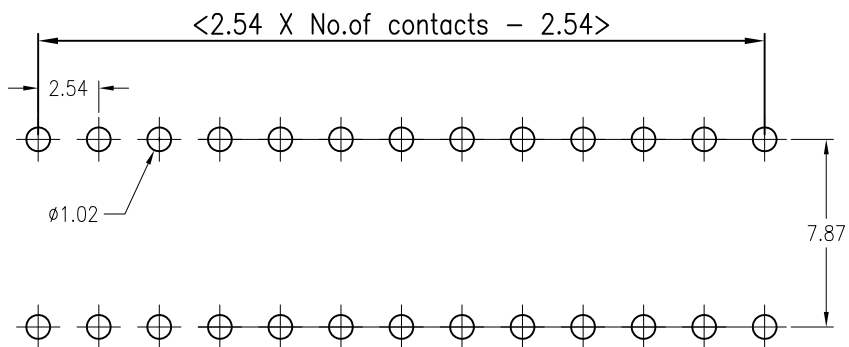

Recommended P.C. Board  
 Hole Layout



				TOLERANCE		 UNITS : mm		OLD PART NO.		TITLE	
				.0 = ±.30		SCALE NONE		DRAWER 袁丽娟		FEMALE HEADER 2.54mm	
B 更新圖面		2019/05/24		.00 = ±.25		SIZE A4		CHECK 李劍		SIDE ENTRY	
A RELEASE		2017/02/16		.0000 = ±.XXX		SHEET 1 OF 1		REV. B		NEW PART NO. 61B-91-xxGB1R	
REV. DESCRIPTION		DATE		ANG. = ±3°				APP'D 李劍		DRAW NO. 61B-91-xxGB1R(B版)	