

REVISIONS

P	LTR	DESCRIPTION	DATE	DWN	APVD
	A	ECN-24-279729	14AUG2024	CD	CD

- 1 MATERIALS:
 MAIN HOUSING: GLASS-FILLED THERMOPLASTIC,
 UL 94V-0 RATED; COLOR: BLACK
 BACK HOUSING: GLASS-FILLED THERMOPLASTIC,
 UL 94V-0 RATED; COLOR: GREY
 DIMMING CONTACTS (0 OR 4): COPPER ALLOY
 LINE VOLTAGE CONTACTS (3): COPPER ALLOY
 WIRE SPRINGS: STAINLESS STEEL
 GASKET: SILICONE; COLOR: BLUE
 SCREW: STAINLESS STEEL
- 2 FINISH:
 DIMMING CONTACTS (0 OR 4): NICKEL UNDERPLATE ENTIRE CONTACT
 0.127 µm MIN THICK. GOLD PLATE CONTACT PAD AREA (MATING FACE
 SIDE ONLY) 0.76 µm MIN THICK. MATTE TIN PLATE TAB ON BOTH SIDES
 0.30 µm MIN THICK.
 LINE VOLTAGE CONTACTS (3): NONE.
- 3 LINE VOLTAGE TERMINATIONS (3):
 18 AWG, 0.75mm² AND/OR 1.5mm² SOLID OR TIN DIPPED WIRE ACCEPTED
 Ø1.70 MAX OD CONDUCTOR; Ø3.60 MAX OD INSULATION
 NOTE COLOR RECOMENDATIONS
- 4 DIMMING CONTACT TERMINATIONS (IF APPLICABLE):
 18 AWG, 0.50mm² AND/OR 0.75mm² SOLID OR TIN DIPPED WIRE ACCEPTED
 Ø1.35 MAX OD CONDUCTOR; Ø2.80 MAX OD INSULATION
 NOTE COLOR RECOMENDATIONS
 HOLES BLOCKED FOR 2439396-2
- 5 MATING INTERFACE PER ANSI C136.41-2013.
- 6 USE M4 PLASTIC THREAD FORMING SCREW; TORQUE PER 114-160697
- 7. THIS PRODUCT HAS NOT COMPLETED VALIDATION TESTING

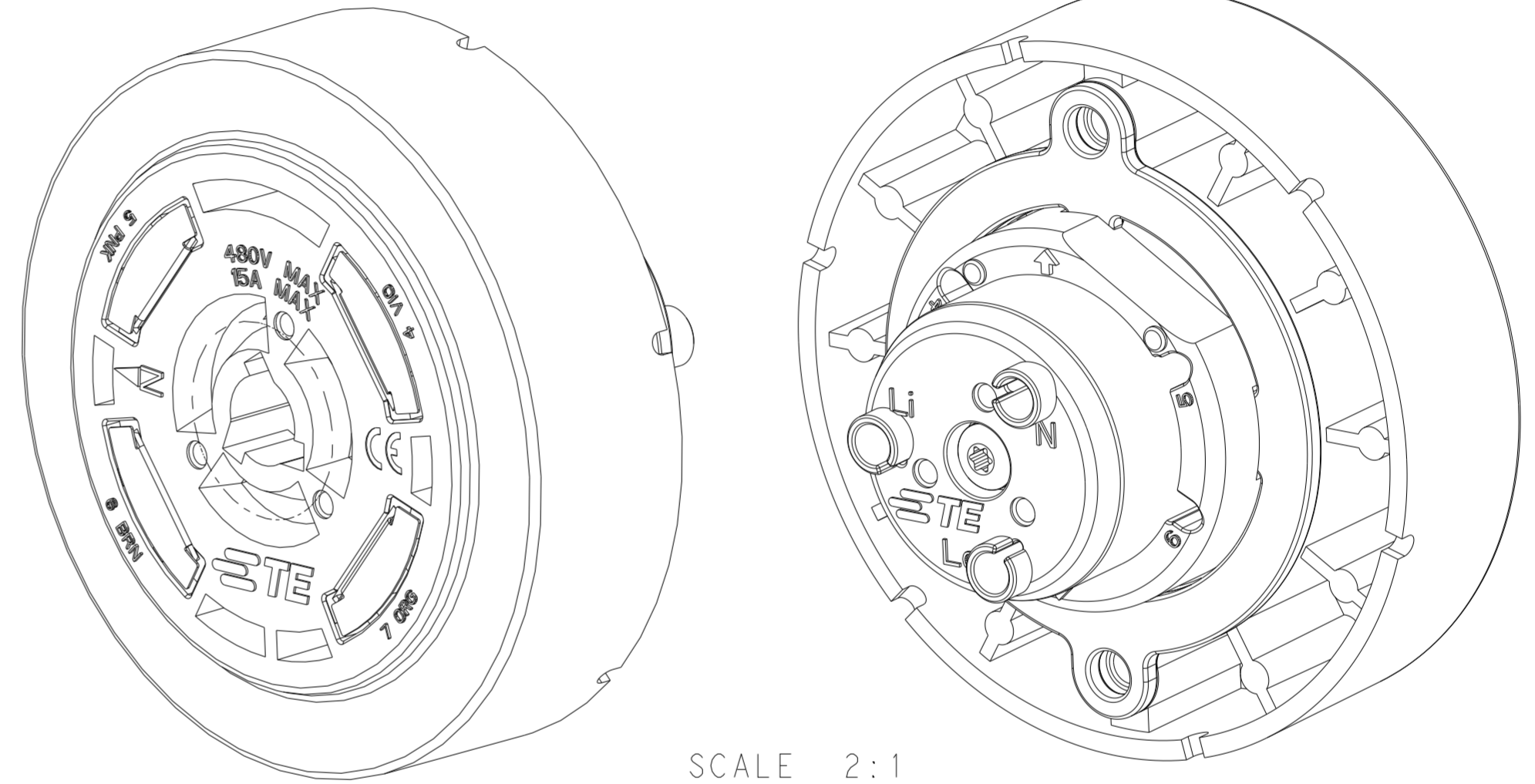

0	2439396-2
4	2439396-1
NUMBER OF DIMMING CONTACTS	PART NO.

THIS DRAWING IS A CONTROLLED DOCUMENT.		DWN C. DAILY	16AUG2023	STE TE Connectivity																					
		CHK M. MOSTOLLER	16AUG2023																						
DIMENSIONS: mm		TOLERANCES UNLESS OTHERWISE SPECIFIED:		NAME RECEPTACLE ASSEMBLY, LUMAWISE ENDURANCE N POKE IN POKE-IN																					
<table border="0"> <tr> <td>0 PLC</td> <td>±</td> <td></td> </tr> <tr> <td>1 PLC</td> <td>±0.2</td> <td></td> </tr> <tr> <td>2 PLC</td> <td>±0.13</td> <td></td> </tr> <tr> <td>3 PLC</td> <td>±</td> <td></td> </tr> <tr> <td>4 PLC</td> <td>±</td> <td></td> </tr> <tr> <td>ANGLES</td> <td>±</td> <td>±2°</td> </tr> <tr> <td>FINISH</td> <td></td> <td></td> </tr> </table>		0 PLC	±		1 PLC	±0.2		2 PLC	±0.13		3 PLC	±		4 PLC	±		ANGLES	±	±2°	FINISH			APVD		PRODUCT SPEC 108-161063
0 PLC	±																								
1 PLC	±0.2																								
2 PLC	±0.13																								
3 PLC	±																								
4 PLC	±																								
ANGLES	±	±2°																							
FINISH																									
MATERIAL		APPLICATION SPEC 114-160697		SIZE A2	CAGE CODE 00779																				
<table border="0"> <tr> <td>1</td> <td>2</td> </tr> </table>		1	2	WEIGHT -		DRAWING NO C-2439396	RESTRICTED TO -																		
1	2																								
CUSTOMER DRAWING				SCALE 1:2	SHEET 1 OF 2																				
				REV A																					

P	LTR	DESCRIPTION	DATE	DWN	APVD
-	-	SEE SHEET 1	-	-	-

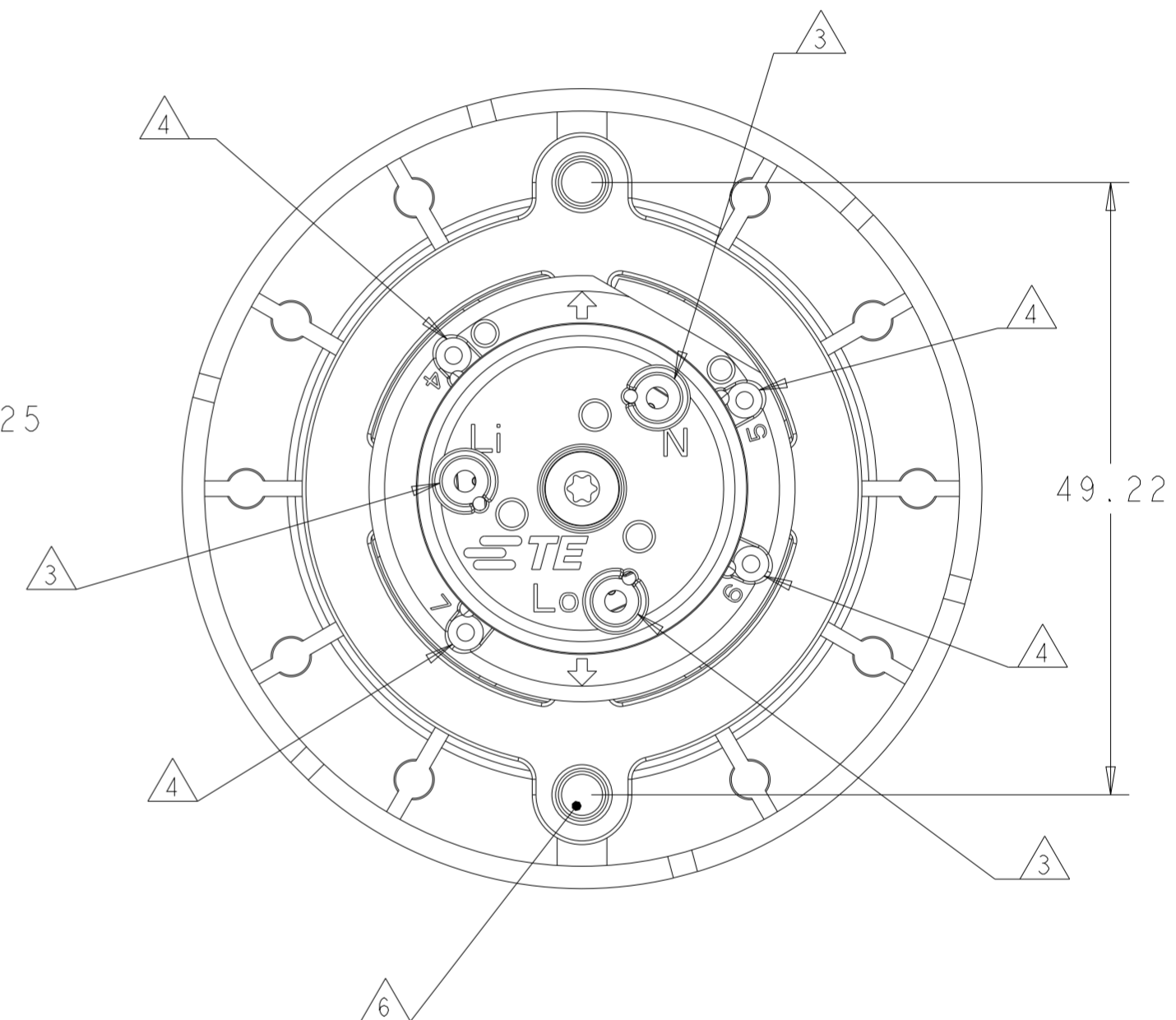
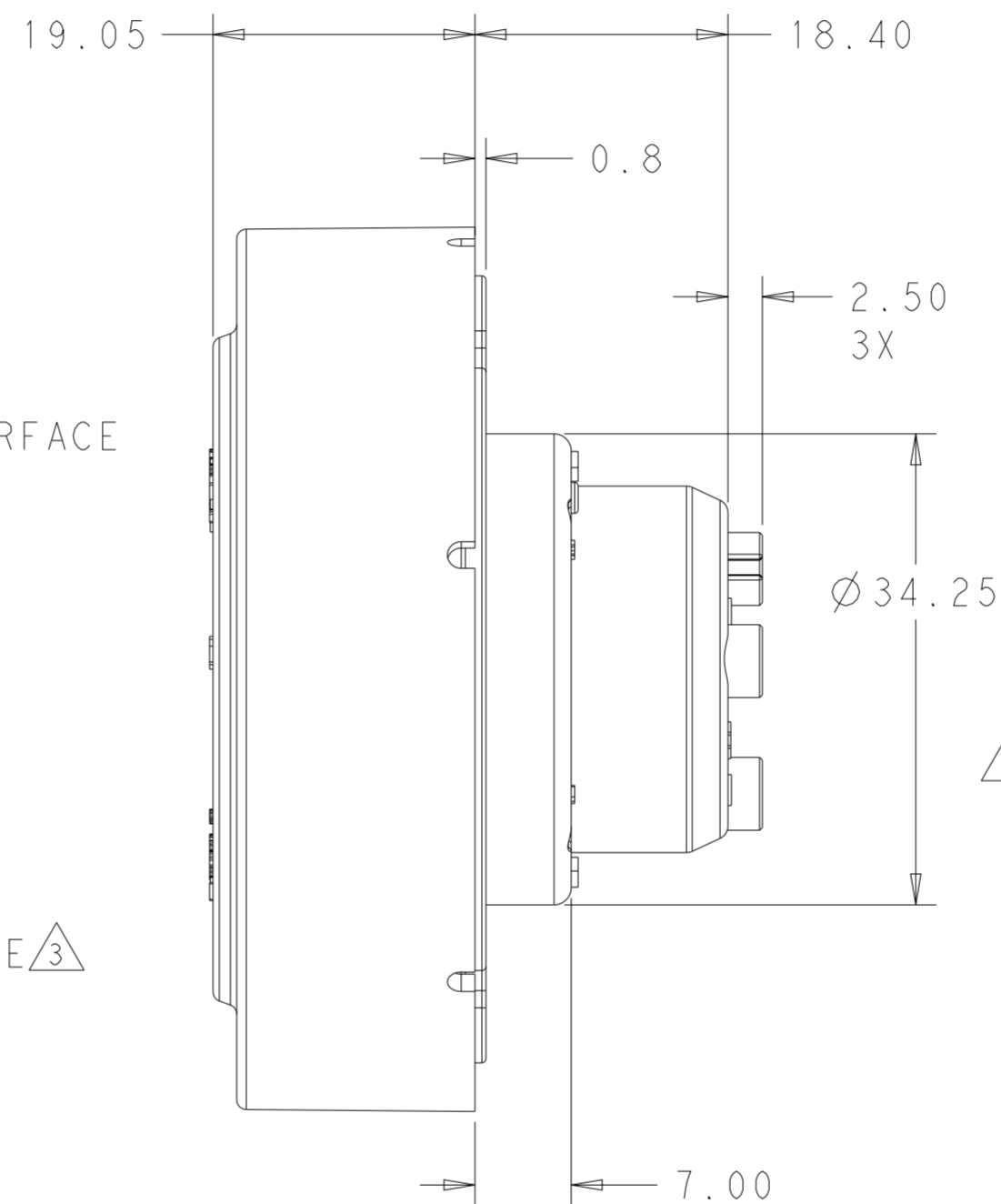
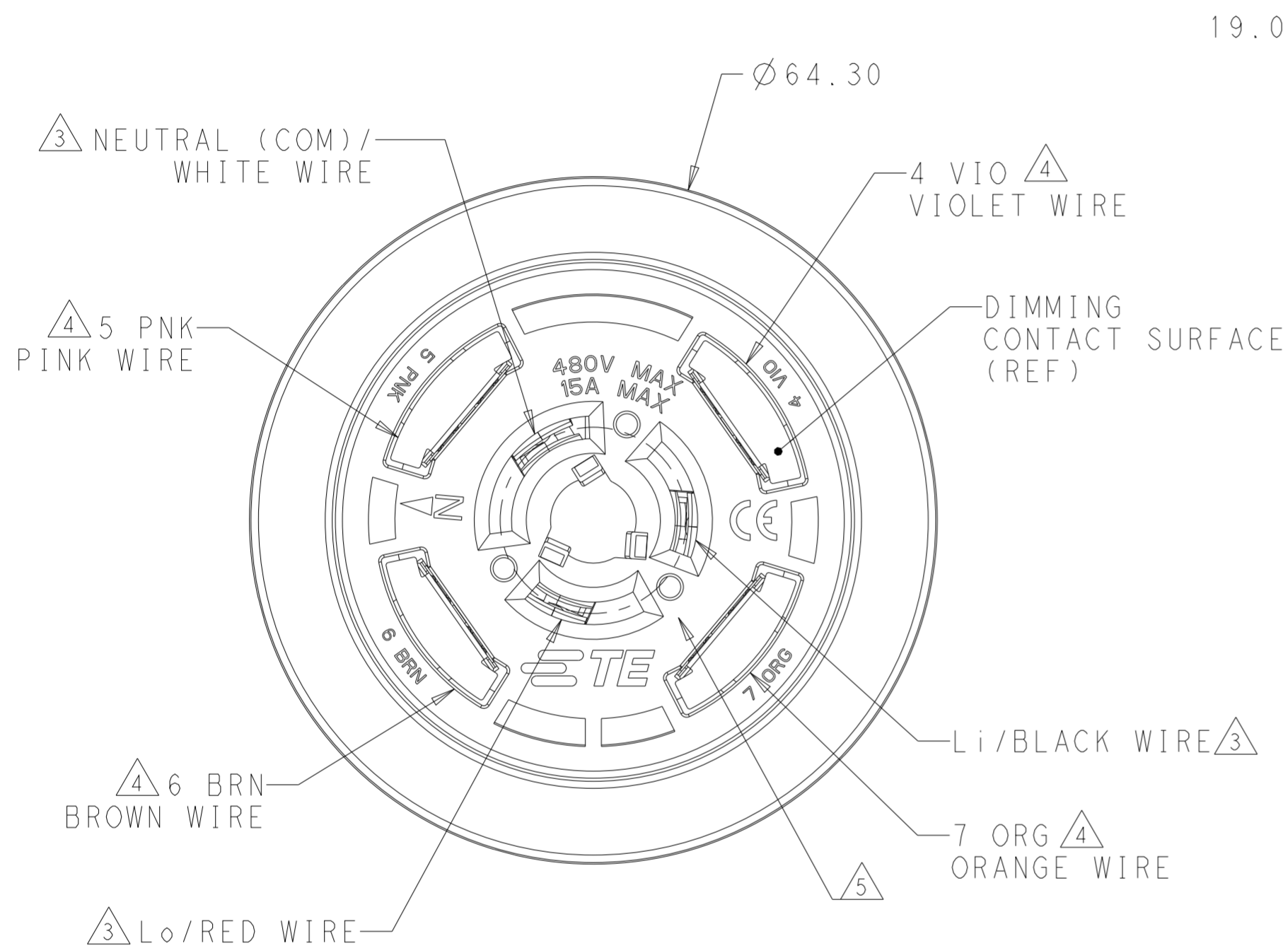

2439396-X
ASSEMBLED VIEW
SCALE 2:1

THIS DRAWING IS A CONTROLLED DOCUMENT.		DWN C. DAILY 16AUG2023	TE Connectivity	
		CHK M. MOSTOLLER 16AUG2023		
DIMENSIONS: mm		APVD	NAME RECEPTACLE ASSEMBLY, LUMAWISE ENDURANCE N POKE IN POKE-IN	
TOLERANCES UNLESS OTHERWISE SPECIFIED: 0 PLC ± 1 PLC ±0.2 2 PLC ±0.13 3 PLC ± 4 PLC ± ANGLES ±2° FINISH		PRODUCT SPEC 108-161063	RESTRICTED TO	
MATERIAL		APPLICATION SPEC 114-160697	SIZE A2	CAGE CODE 00779
		WEIGHT	DRAWING NO C-2439396	
		CUSTOMER DRAWING	SCALE 1:2	SHEET 2 OF 2
			REV A	