

# SERIES 3006 - TACT SWITCHES

TO 50 mA 28 V

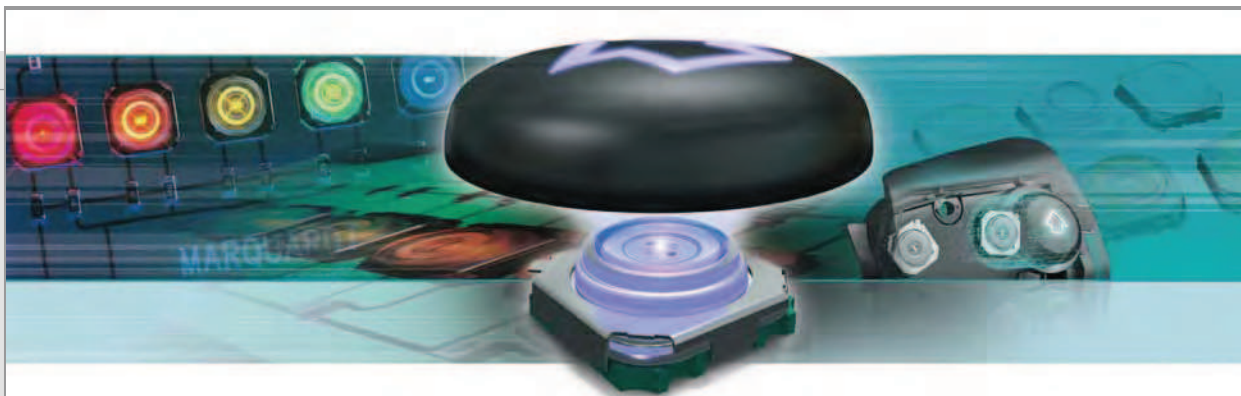

## PRODUCT FEATURES

- ◆ Low height even with integrated LED
- ◆ SMD connection technique
- ◆ Pleasant actuating characteristic thanks to clearly tangible pressure point
- ◆ Extremely large actuator surface
- ◆ Six standard colors
- ◆ Two operating force variants
- ◆ Reflow lead-free solderable

## ON REQUEST

- ◆ Other LED colors
- ◆ Different brightness groups

Mechanical life endurance	50E4
Contact resistance (new condition)	< 100 mOhm
Protection type	IP 50
Ambient temperature	-40 °C ... +95 °C (1 h bis +120 °C)
Material terminals	gold plated
Bounce time	< 5 ms
Packing unit	1 800 pieces in blister belt on a roller
Miscellaneous	rating max. 1 W voltage range 20 mV - 28 V current range 10 µA - 50 mA



ROCKER SWITCHES

PUSHBUTTON SWITCHES

TOGGLE SWITCHES

SLIDE SWITCHES

ROTARY SWITCHES

FOOT SWITCHES

TACT AND KEY SWITCHES













SNAP-ACTION SWITCHES

MICRO-SIGNAL SWITCHES

SENSORS

# SERIES 3006 - TACT SWITCHES

TO 50 mA 28 V

 single-pole	50 mA 28 V	Contact material	Operating force in N	Operating position (OP) in mm	Free position (FP) max. in mm	Permissible total travel position (TP) in mm	Color lamp	Miscellaneous	Stock version
<b>Normally open contact (SPNO)</b>									
<b>3006.2100</b>	●	Au	4 +1 -0.5	3.2 ±0.2	4.15	2.9		without LED	
<b>3006.2101</b>	●	Au	4 +1 -0.5	3.2 ±0.2	4.15	2.9			
<b>3006.2102</b>	●	Au	4 +1 -0.5	3.2 ±0.2	4.15	2.9			
<b>3006.2104</b>	●	Au	4 +1 -0.5	3.2 ±0.2	4.15	2.9			
<b>3006.2105</b>	●	Au	4 +1 -0.5	3.2 ±0.2	4.15	2.9			
<b>3006.2106</b>	●	Au	4 +1 -0.5	3.2 ±0.2	4.15	2.9		LED white	
<b>3006.2107</b>	●	Au	4 +1 -0.5	3.2 ±0.2	4.15	2.9			
<b>3006.2151</b>	●	Au	4 +1 -0.5	3.2 ±0.2	4.15	2.9		low current consumption reduced brightness	
<b>3006.2300</b>	●	Au	6 +1.5 -0.75	3.2 ±0.2	4.15	2.9		without LED	
<b>3006.2301</b>	●	Au	6 +1.5 -0.75	3.2 ±0.2	4.15	2.9			
<b>3006.2306</b>	●	Au	6 +1.5 -0.75	3.2 ±0.2	4.15	2.9		LED white	

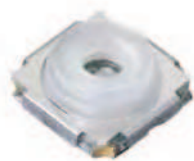

Basic type 3006

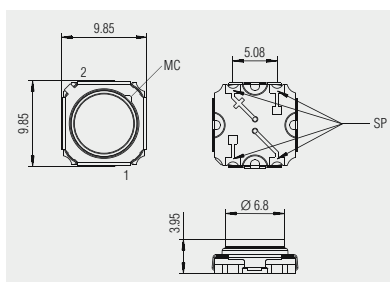

SMD connection technique

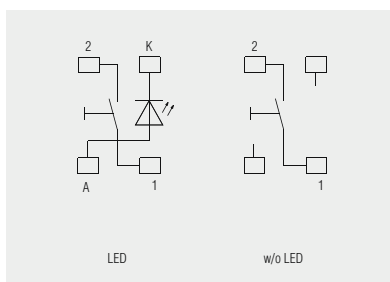

Circuit diagram with / without LED

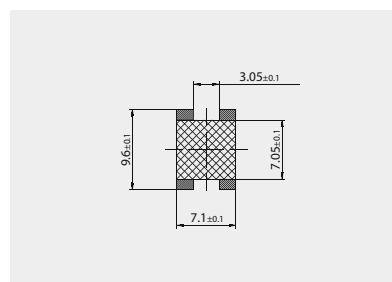

Solder pad design

ROCKER SWITCHES

PUSHBUTTON SWITCHES

TOGGLE SWITCHES

SLIDE SWITCHES

ROTARY SWITCHES

FOOT SWITCHES

TACT AND KEY SWITCHES

SNAP-ACTION SWITCHES

MICRO-SIGNAL SWITCHES

SENSORS