

Recommended PCB Layout

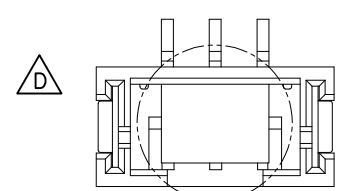

Cap Dimension:

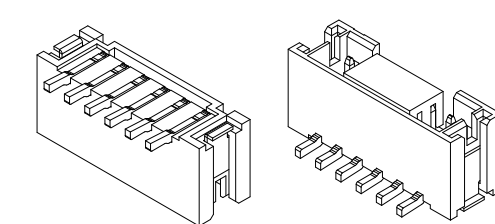
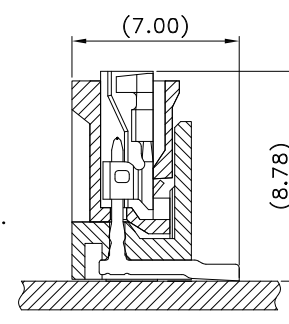
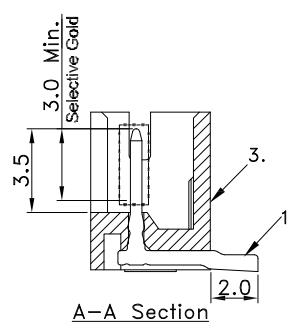
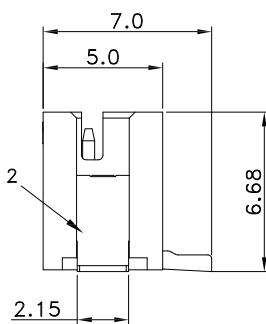
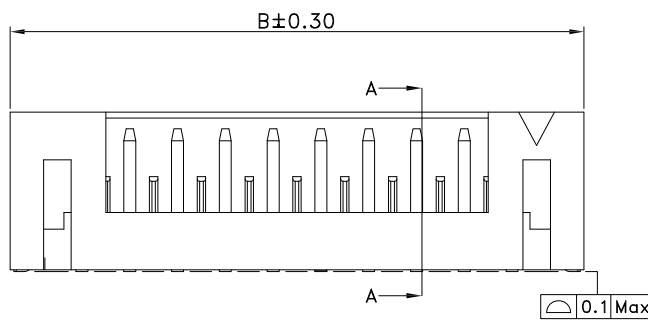
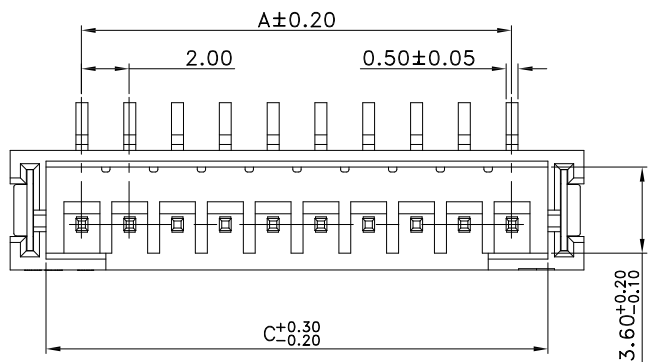
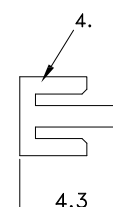
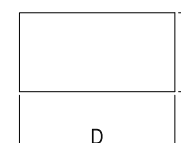

Poles	D
02~03	4.50
04~16	6.50

**SPECIFICATIONS**  
 Voltage Rating: 100V AC/DC  
 Current Rating: 2A AC/DC  
 Withstanding Voltage: 800V AC/minute  
 Insulation Resistance: 1000MΩ min  
 Temperature Range: -40°C to +105°C  
 Contact Resistance: 20mΩmax

**MATERIAL**  
 Contact: Phos. Bronze, Tin Plated  
 Base: Nylon 9T UL94V-0  
 Cap: Nylon PA46 UL94V-0

721-9 3- xx T W E9  
 1 2 3 4 5 6

- 9: Green Product High Temp
- 3: SMT Straight type
- 4: SMT Right angle type
- No. of contacts per row
- G: Gold flash
- T: Tin plated
- B: Black Insulator
- W: White Insulator
- Pinrex internal code.



Poles	Dimensions(mm)		
	A	B	C
2	2.00	8.00	5.00
3	4.00	10.00	7.00
4	6.00	12.00	9.00
5	8.00	14.00	11.00
6	10.00	16.00	13.00
7	12.00	18.00	15.00
8	14.00	20.00	17.00
9	16.00	22.00	19.00
10	18.00	24.00	21.00
11	20.00	26.00	23.00
12	22.00	28.00	25.00
13	24.00	30.00	27.00
14	26.00	32.00	29.00
15	28.00	34.00	31.00
16	30.00	36.00	33.00

D	更新圖面	2023/06/20	TOLERANCE		OLD PART NO.	TITLE	頻銳科技股份有限公司 PINREX TECHNOLOGY CORP.
C	UPDATE	2020/07/13	.0 = ±.30		UNITS : mm	2.0mm WIRE TO BOARD HEADER	
B	增加尺寸及修改尺寸	2017/09/27	.00 = ±.20	SCALE NONE SIZE A4	DRAWER 李孟瑤	SMT 180° TYPE CAP+T/R	DRAW NO. 721-93-xxTWE9(D版)
A	RELEASE	2011/12/05	.000 = ±.10		SHEET 1 OF 1	CHECK 李劍	
REV.	DESCRIPTION	DATE	.0000 = ±.0000	REV. D	APP'D 李劍		
			ANG. = ±1°				