

THIS DRAWING IS UNPUBLISHED. RELEASED FOR PUBLICATION
 © COPYRIGHT - By - ALL RIGHTS RESERVED.

REVISIONS					
P	LTR	DESCRIPTION	DATE	DWN	APVD
T		REVISED PER ECO-16-004940	29JUL2016	NK	MZ
U		REVISED PER ECO-18-000437	18JAN2018	RS	MZ

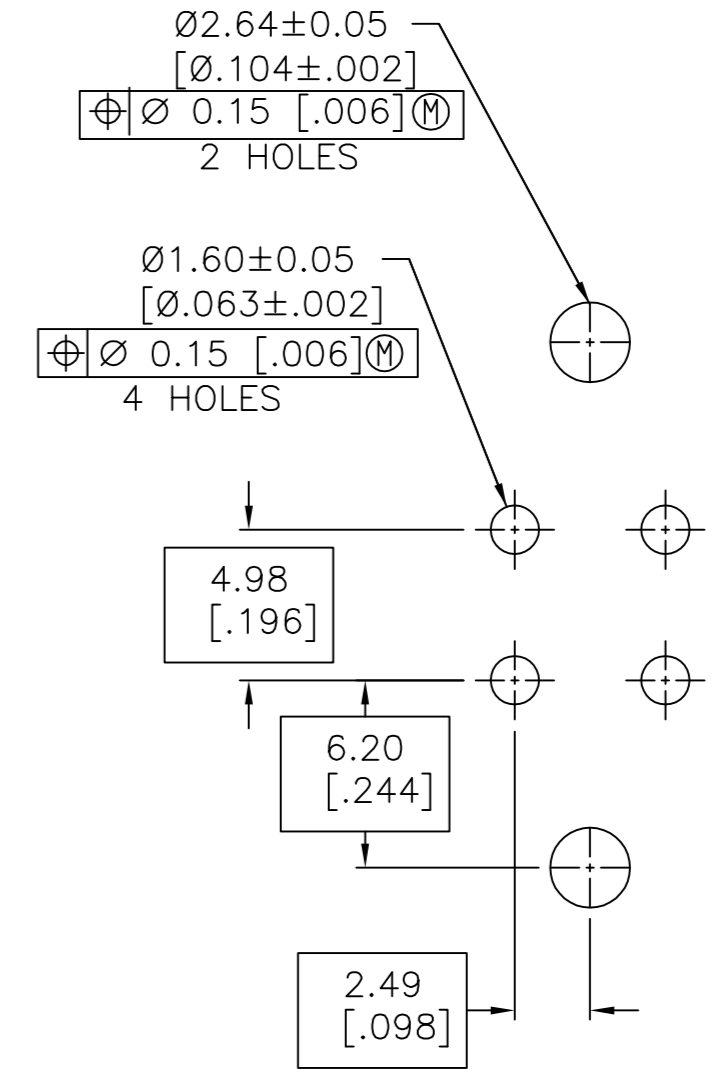
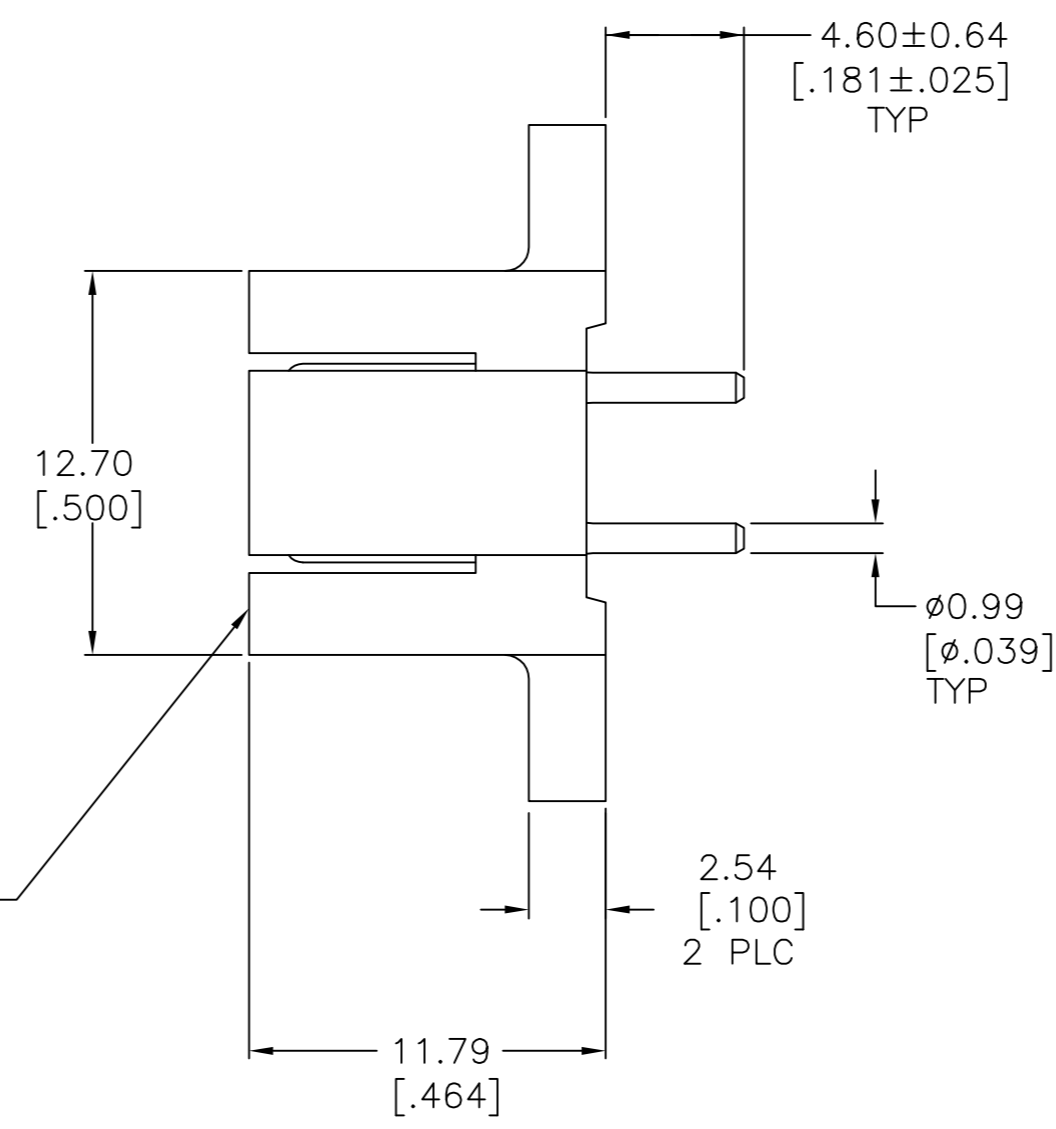
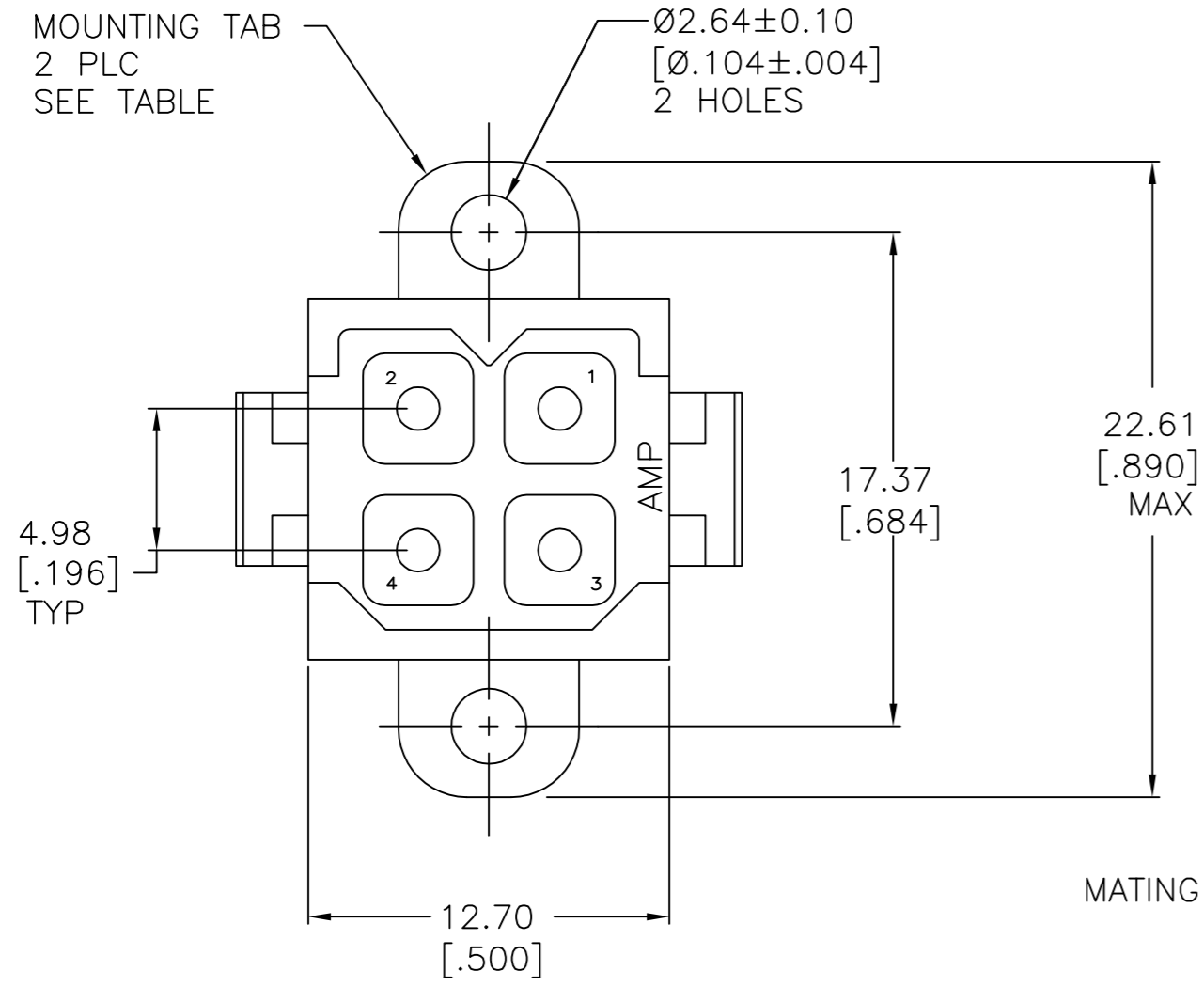

RECOMMENDED PC BOARD LAYOUT

- ① NYLON, UL 94V-0 RATED, RED.
- ② BRASS PER ASTM B36.
- ③ 3.81µm [.000150] MIN TIN OVER 2.54µm [.000100] MIN COPPER.
- ④ 0.76µm [.000030] MIN GOLD FOR A LENGTH OF 5.08 [.200] FROM MATING END, 3.81µm [.000150] MIN TIN FOR A LENGTH OF 4.83 [.190] MIN FROM OPPOSITE END, BOTH OVER 1.27µm [.000050] MIN NICKEL.
- ⑤ CONTACTS SELECT LOADED IN POSITIONS 2, 3 AND 4.
- ⑥ 3.81µm [.000150] MIN TIN OVER 2.54µm [.000100] MIN COPPER.
- ⑦ 0.76µm [.000030] MIN GOLD FOR A LENGTH OF 5.08 [.200] FROM MATING END, 3.81µm [.000150] MIN TIN FOR A LENGTH OF 4.83 [.190] MIN FROM OPPOSITE END, BOTH OVER 1.27µm [.000050] MIN NICKEL.
- ⑧ OBSOLETE PARTS: OBSOLETE CIS STREAMLINING PER D.RENAUD/D.SINISI

⑧/⑤	OBSOLETE	⑥	YES	1-207119-2
	OBSOLETE	⑦	NO	1-207119-1
		⑦	YES	1-207119-0
		⑥	NO	207119-9
		⑥	YES	207119-8
⑧/⑤	OBSOLETE	③	YES	207119-7
	OBSOLETE	④	NO	207119-4
	OBSOLETE	④	YES	207119-3
	OBSOLETE	③	NO	207119-2
	OBSOLETE	③	YES	207119-1

THIS DRAWING IS A CONTROLLED DOCUMENT.		DWN	03/10/92	L.SIPE	
DIMENSIONS: mm [INCHES]		CHK	3-17-92	R.STONE	
TOLERANCES UNLESS OTHERWISE SPECIFIED:		APVD	-	NAME	
0 PLC ± -		PRODUCT SPEC		108-10033	
1 PLC ± -		APPLICATION SPEC		-	
2 PLC ± 0.25 [.010]		WEIGHT		-	
3 PLC ± -		SCALE		A2	
4 PLC ± -		SHEET		1 of 1	
ANGLES ± -		CUSTOMER DRAWING		SCALE 4:1	
FINISH		CONTACT: SEE TABLE		SHEET 1 of 1	
MATERIAL HOUSING: 1		CAGE CODE		00779	
		DRAWING NO		C=207119	
		RESTRICTED TO		-	
		REV		U	