

CONFIDENTIAL

VERTRAULICH

Alle Rechte bei Marquardt, auch fuer den Fall von Schutzrechtsanmeldungen. Jede Veruegungsbefugnis, wie Kopier- und Weitergaberecht, bei uns.

THIS DRAWING IS THE EXCLUSIVE PROPERTY OF MARQUARDT. WITHOUT THEIR CONSENT IT MAY NOT BE REPRODUCED OR GIVEN TO THIRD PARTIES.

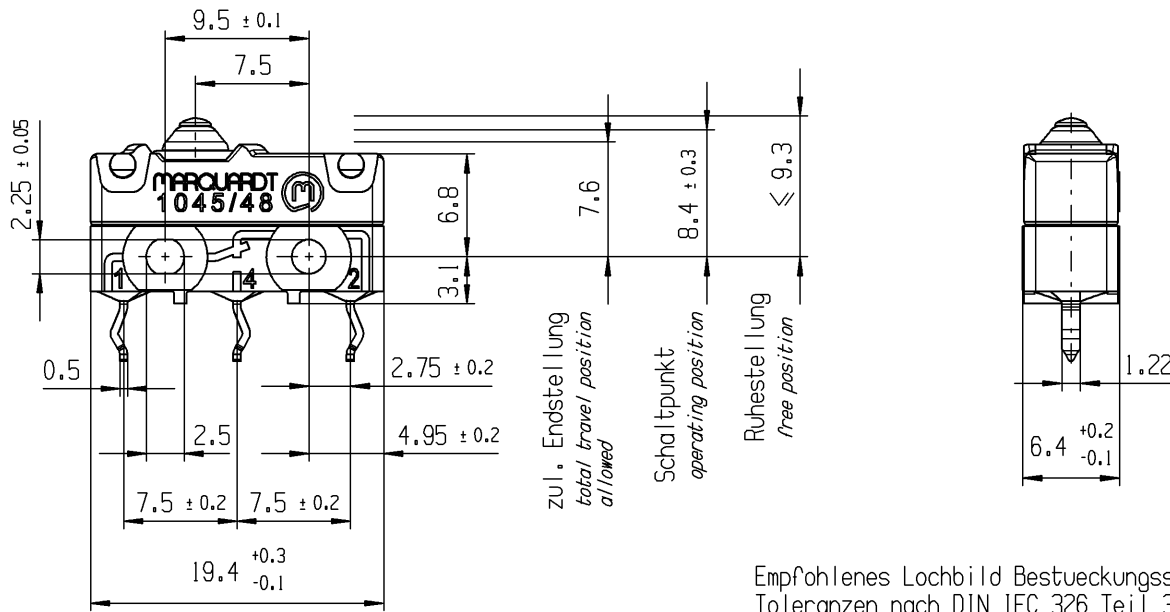

Empfohlenes Lochbild Bestueckungsseite  
Toleranzen nach DIN IEC 326 Teil 3 sehr fein  
Recommended hole pattern component side  
tolerances acc. to DIN IEC 326 item 3 very fine

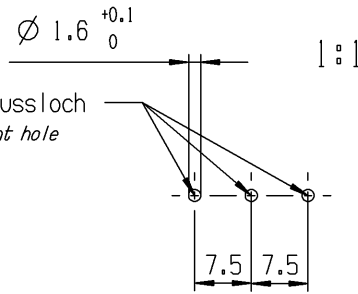

Aufschrift  
marking

MARQUARDT 1045/48

2(1)A 250V AC  
IE5

μ

Herstellort/-jahr/-monat/-tag  
Code of manufacture:  
place/year/month/day

Auf Verpackung/ on box: G

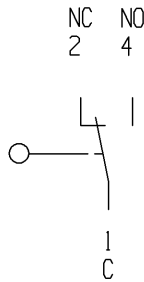

Wechsler 1-polig  
single pole changeover

Schaltbetaetigungskraft  
actuating force ≤ 1.9 N

Rueckschaltkraft  
release force ≥ 0.5 N

Differenzweg  
movement differential ≤ 0.2 mm

IP Schutzklasse nach EN 60529 IP 67  
protection class acc to EN 60529 IP 67

G: Konform nach IEC 60335-1:2001 Kap. 30  
G: matching IEC 60335-1:2001 clause 30

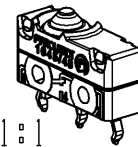

-	-	-	1045.2101-XX																																				
Figure	Type	Customer No.	Art.No.-PI																																				
Shape and location	Angle ± 2°	Sheet 01	Ident. K																																				
	Edge tolerance	Format DIN A4	Document number 10452101																																				
0.1	<table border="1"> <thead> <tr> <th colspan="2">Length</th> <th colspan="2">Radii</th> </tr> </thead> <tbody> <tr> <td>0-6</td> <td>± 0.1</td> <td>0-6</td> <td>± 0.2</td> </tr> <tr> <td>&gt;6-15</td> <td>± 0.15</td> <td>&gt;6-15</td> <td>± 0.3</td> </tr> <tr> <td>&gt;15-30</td> <td>± 0.2</td> <td>&gt;15-30</td> <td>± 0.5</td> </tr> <tr> <td>&gt;30-70</td> <td>± 0.3</td> <td>&gt;30-200</td> <td>± 10%</td> </tr> <tr> <td>&gt;70-120</td> <td>± 0.4</td> <td></td> <td></td> </tr> <tr> <td>&gt;120-200</td> <td>± 0.8</td> <td></td> <td></td> </tr> <tr> <td></td> <td>±</td> <td></td> <td></td> </tr> <tr> <td></td> <td>±</td> <td></td> <td></td> </tr> </tbody> </table>	Length		Radii		0-6	± 0.1	0-6	± 0.2	>6-15	± 0.15	>6-15	± 0.3	>15-30	± 0.2	>15-30	± 0.5	>30-70	± 0.3	>30-200	± 10%	>70-120	± 0.4			>120-200	± 0.8				±				±			Projection  Scale 2:1	Index j
	Length		Radii																																				
0-6	± 0.1	0-6	± 0.2																																				
>6-15	± 0.15	>6-15	± 0.3																																				
>15-30	± 0.2	>15-30	± 0.5																																				
>30-70	± 0.3	>30-200	± 10%																																				
>70-120	± 0.4																																						
>120-200	± 0.8																																						
	±																																						
	±																																						
j	140395	2021-11-11	PANDHAREA																																				
i	136255	2021-02-23	HHE																																				
h	130794	2020-02-18	HHE																																				
g	126682	2019-08-30	LEK																																				
Index	MEC-No.	Date (YYYY-MM-DD)	Edited by																																				

