

# 2J560

## (DATASHEET)

**Type**  
**Frequencies**

Patch antenna  
AMPS (824-894 MHz)  
ISM (868 MHz)  
GSM (900 MHz)  
DCS (1800 MHz)  
PCS (1900 MHz)  
3G (UMTS 2.1 GHz)  
WIFI / BLUETOOTH (2.4 GHz)  
WIFI (5.0 GHz)

**Mounting**  
**Revision**

Embedded/Patch Mount  
00

**Application**

Mobile applications  
Wireless applications  
Smart meters

  
P. Tipul

## 1. SPECIFICATION

### 1.1. *Electrical Specifications*

Frequencies	AMPS (824-894 MHz) ISM (868 MHz) GSM (900 MHz) DCS (1800 MHz) PCS (1900 MHz) 3G (UMTS 2.1 GHz) WIFI / BLUETOOTH (2.4 GHz) WIFI (5.0 GHz)
Impedance	50 Ohms
Polarization	Vertical
Gain	2.2 dBi
VSWR	<2:1
Power handling	35W
Operating temperature	-40°C to +85°C

### 1.2. *Connection Specifications*

- Cable type and connector are upon request.
- Minimum cable length what is suitable for this antenna is 30cm

### 1.3. *Mechanical Specifications and Dimensions*

#### 1.3.1. Glass mount

Max. dimensions: 116mm x 6.7mm x 22mm  
 Weight: 17 g 'weight with 30cm cable length and SMA connector'  
 Colour: Black solder mask on bottom side of PCB

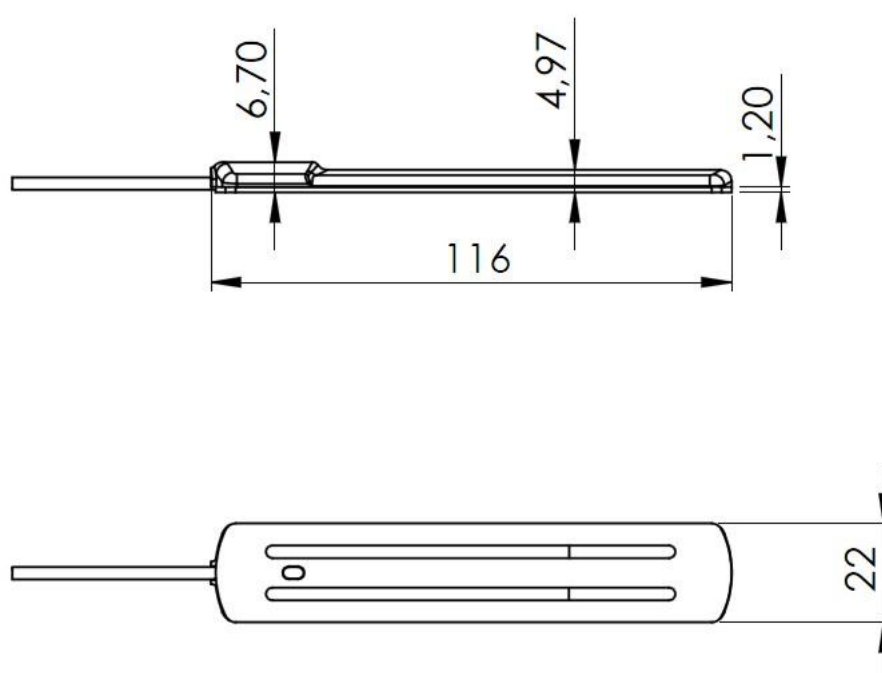

## 2. MEASUREMENT

Log Mag (WiFi 5GHz)

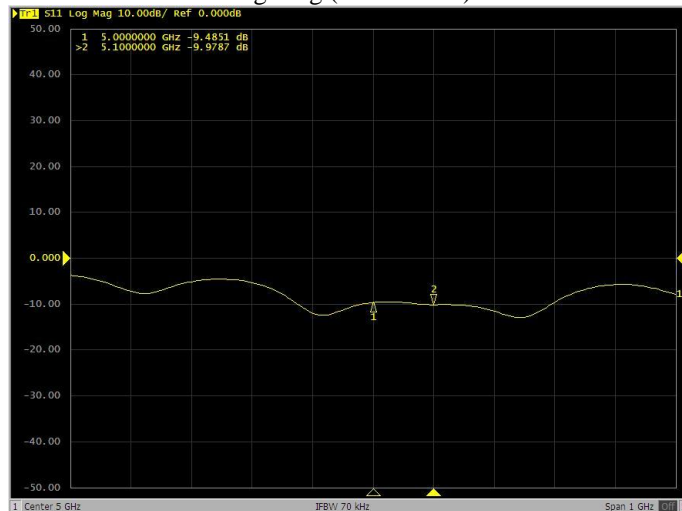

Tested with 30cm cable length

Log Mag (Quad Band + WiFi)

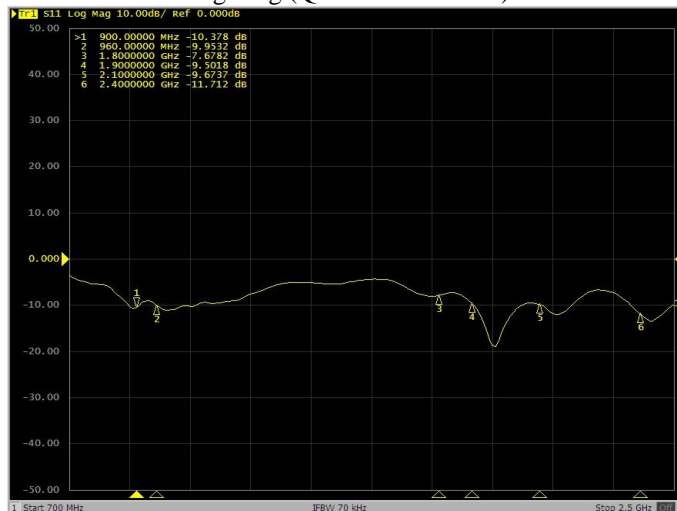

Tested with 30cm cable length

VSWR (WiFi 5GHz)

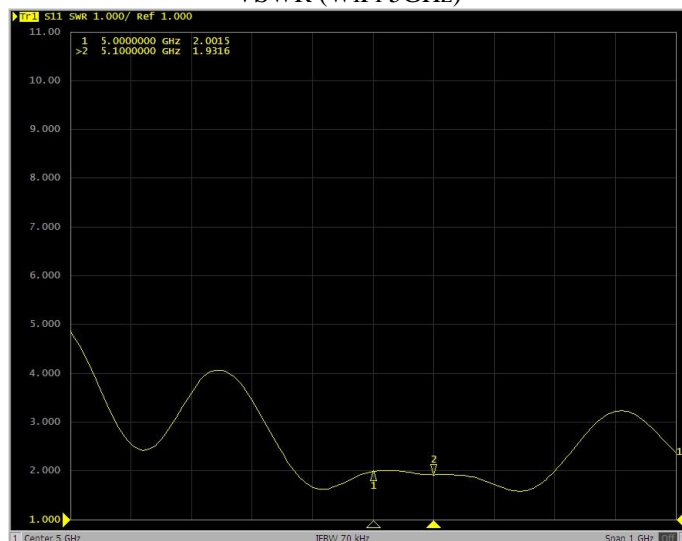

Tested with 30cm cable length

VSWR (Quad Band + WiFi)

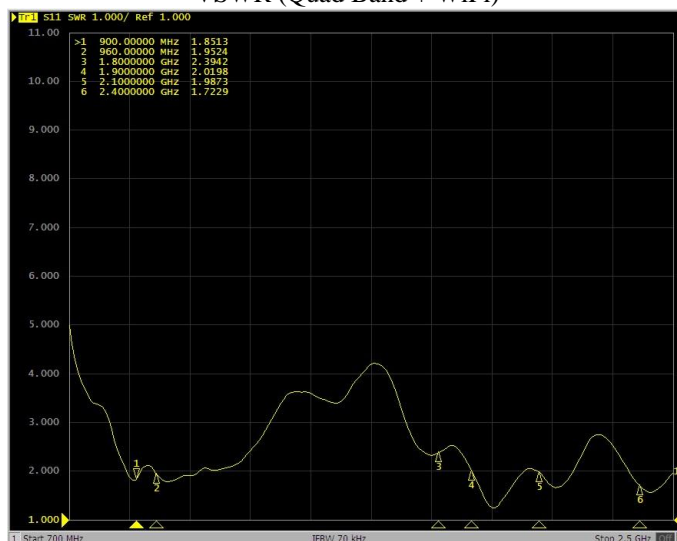

Tested with 30cm cable length

Log Mag (WiFi 5GHz)

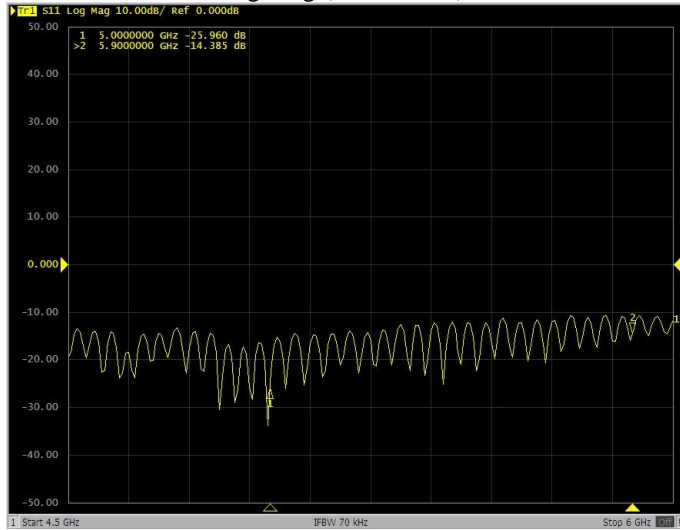

Tested with 2.5m cable length

Log Mag (Quad Band + WiFi)

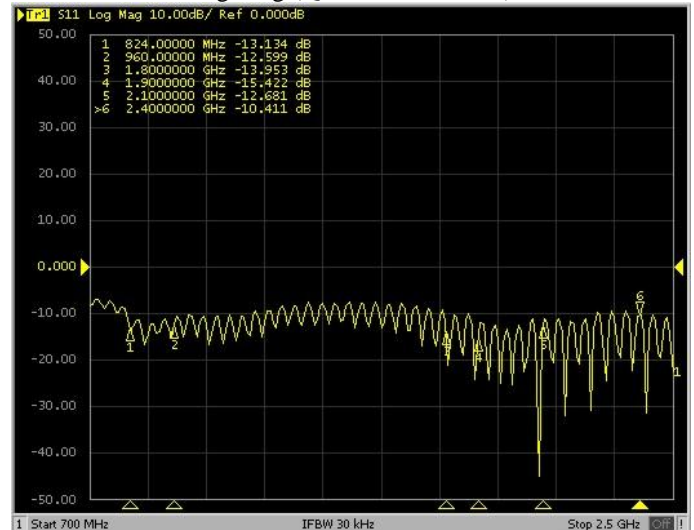

Tested with 2.5m cable length

VSWR (WiFi 5GHz)

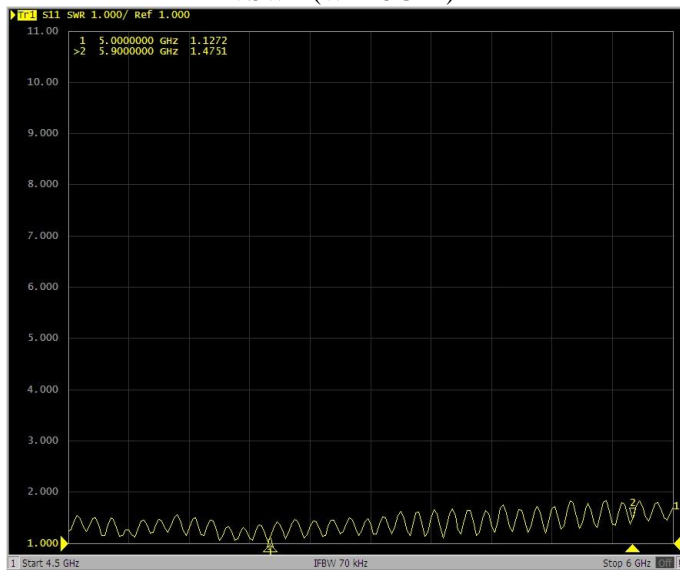

Tested with 2.5m cable length

VSWR (Quad Band + WiFi)

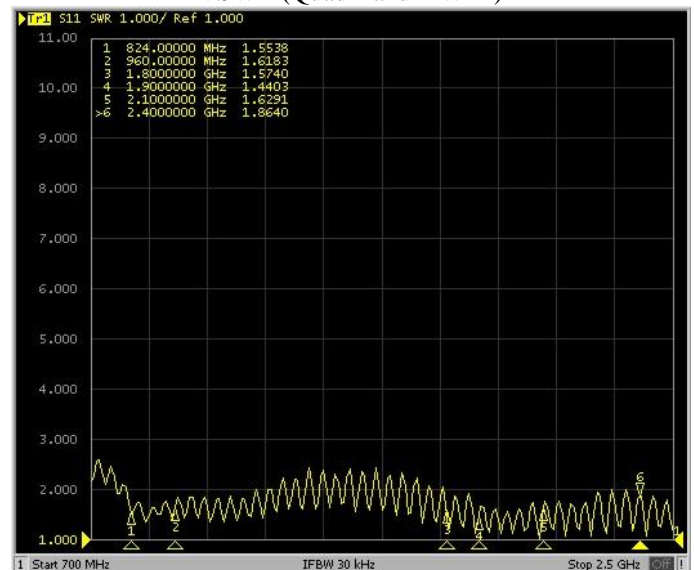

Tested with 2.5m cable length