

RATINGS:

CURRENT: 10 AMPS

BREAKDOWN VOLTAGE: 5700 V RMS

CONTACT RESISTANCE: 0.010 OHMS MAX.

CONTACT-TO-PANEL C: 2 pF NOMINAL

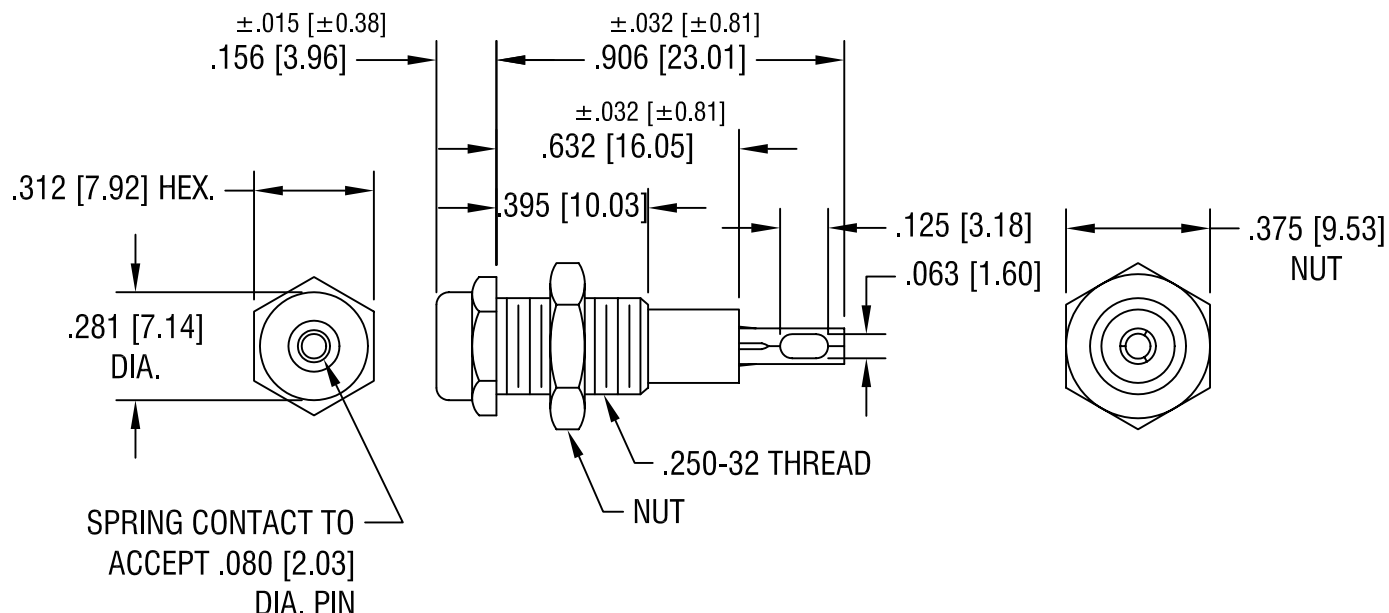

NOTES:

1. CONTACT:

MAT'L - PHOSPHOR BRONZE

SILVER PLATE

BODY:

MAT'L - NYLON 6/6 PER ASTM D4066

2. SHELL, NUT:

BRASS, NICKEL PLATE.

HARDWARE SUPPLIED

UNASSEMBLED.

PART NO.	COLOR
6024	WHITE
6025	RED
6026	BLACK
6027	GREEN
6028	YELLOW
6029	BLUE

2.5.03 CHANGE AS PER ECN 03-012

A

KEYSTONE ELECTRONICS CORP.

ASTORIA, N.Y. 11105-2017

PART NAME

INSULATED METAL-CLAD TIP JACK

MATERIAL

AS NOTED

FINISH

AS NOTED

DRN BY

BOONE

DATE

12.7.82

APPD

LN

SCALE

2X

TOLERANCES

INCH [MM]

DECIMAL ±.005 [±0.15]

ANGULAR ± 1°

UNLESS OTHERWISE SPECIFIED

CODE

C/M

DWG NO.

6024-6029

DATE

DESCRIPTION

REV.