

THIS DRAWING IS UNPUBLISHED. RELEASED FOR PUBLICATION
 © COPYRIGHT - By - ALL RIGHTS RESERVED.

REVISIONS					
P	LTR	DESCRIPTION	DATE	DWN	APVD
S		REVISED PER ECO-15-011608	04NOV2015	NK	MZ
T		REVISED PER ECO-17-013721	16NOV2017	RS	MZ

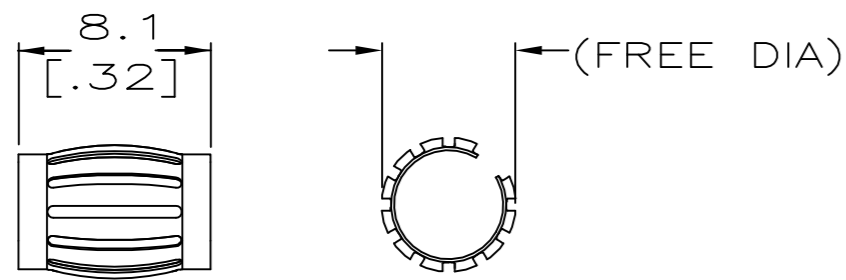

STYLE B
(MALE)

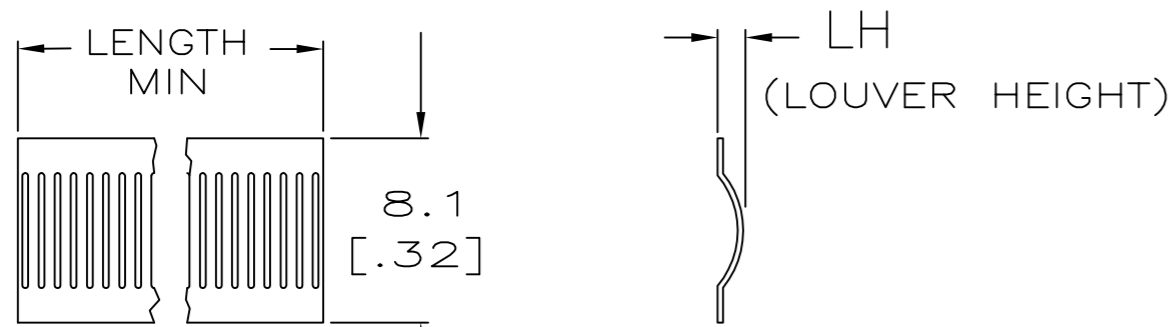

STYLE C
(STRIP)

- 1 FINISH-SILVER PLATE 200 μIN MIN THICK.
- 2 FINISH-NICKEL PLATE 40 μIN MIN THICK.
- 3 FINISH-GOLD PLATE 10 μIN MIN THICK.
- 4 FINISH-GOLD PLATE 50 μIN MIN THICK.
- 5 FINISH-CADMIUM PLATE 300 μIN MIN THICK.
- 6 FINISH-NICKEL PLATE 100 μIN MIN THICK.
- 7 FINISH-TIN PLATE 300 μIN MIN THICK.
- 8
- 9
- 10
- 11 PLATING NOTES ARE TO BE INTERPRETED AS FOLLOWS, 6-8 AS 6 OVER 8.
- 12 PRODUCT IS SOLD BY THE FOOT.
- 13 12 FOOT STRIP WOUND TO A ONE INCH INSIDE DIAMETER.
- 14 MATERIAL-BeCu (CDA172).
- 15 MATERIAL-STAINLESS STEEL.
- 16 CUT LENGTH 508.0 [20.00] APPROXIMATELY 714 LOUVERS.
- 17 BAND WIDTH .310±.005 FOR P/N 6-192042-6.
- 18 FINISH - GOLD PLATE 30μIN MIN THICK.
- 19 OVERLAPPED WITH GAP.
- 20 OBSOLETE PARTS: OBSOLETE CIS STREAMLINING PER D.RENAUD/D.SINISI
- 21 PRILIMINARY PART

REF	DESCRIPTION	QTY	UNIT	PLATING	MAT'L THK	REF	PART NO.
20	OBSOLETE					04133	4-192042-7
20	OBSOLETE	[.022]	--	B	[.40]	14	9.5 [.375] 36 3-2 0.20 [.008] 04054 4-192042-6
20	OBSOLETE	[.022]	--	B	[.40]	14	9.5 [.375] 36 1-2 0.15 [.006] 04100 4-192042-5
20	OBSOLETE	[.022]	--	B	[.40]	14	9.5 [.375] 36 5 0.15 [.006] 04156 4-192042-4
20	OBSOLETE	[.022]	--		[.40]	14	9.5 [.375] 36 UNPL 0.15 [.006] 04101 4-192042-3
20	OBSOLETE	[.024]	--	B	[.30]	14	7.1 [.280] 26 3-2 0.15 [.006] 04132 4-192042-2
20	OBSOLETE	[.024]	--		[.30]	14	7.1 [.280] 26 UNPL 0.15 [.006] 04131 4-192042-1
20	OBSOLETE	[.024]	--	B	[.30]	14	7.1 [.280] 26 3-2 0.15 [.006] 04048 4-192042-0
20	OBSOLETE	[.024]	--		[.30]	14	7.1 [.280] 26 UNPL 0.15 [.006] 04173 3-192042-9
20	OBSOLETE	[.026]	--	B	[.23]	14	5.5 [.216] 19 6 0.20 [.008] 04043 3-192042-8
20	OBSOLETE	[.026]	--	B	[.23]	14	5.5 [.216] 19 3-2 0.20 [.008] 04135 3-192042-7
20	OBSOLETE	[.026]	--		[.23]	14	5.5 [.216] 19 1-2 0.20 [.008] 04039 3-192042-6
20	OBSOLETE	[.032]	--	B	[.20]	14	4.7 [.185] 15 3-2 0.15 [.006] 04134 3-192042-5
20	OBSOLETE	[.032]	--		[.20]	14	4.7 [.185] 15 UNPL 0.15 [.006] 04034 3-192042-4
20	OBSOLETE	[.022]	--	B	[.17]	14	4.0 [.157] 13 4-2 0.15 [.006] 04033 3-192042-3
20	OBSOLETE	[.022]	--	B	[.17]	14	4.0 [.157] 13 3-2 0.15 [.006] 04032 3-192042-2
20	OBSOLETE	[.022]	--	B	[.17]	14	4.0 [.157] 13 UNPL 0.15 [.006] 04063 3-192042-1
20	OBSOLETE	[.022]	--	B	[.17]	14	4.0 [.157] 13 4-2 0.15 [.006] 04130 3-192042-0
20	OBSOLETE	[.022]	--	B	[.17]	14	4.0 [.157] 13 3-2 0.15 [.006] 04155 2-192042-9
20	OBSOLETE	[.022]	--	B	[.17]	14	4.0 [.157] 13 6 0.15 [.006] 04068 2-192042-8
20	OBSOLETE	[.022]	--	B	[.17]	14	4.0 [.157] 13 1-2 0.15 [.006] 04088 2-192042-7
20	OBSOLETE	[.022]	--	B	[.17]	14	4.0 [.157] 13 UNPL 0.15 [.006] 04087 2-192042-6
20	OBSOLETE	[.022]	--	B	[.15]	14	3.5 [.138] 12 3-2 0.15 [.006] 04089 2-192042-5
20	OBSOLETE	[.022]	--	B	[.14]	14	3.0 [.118] 10 3-2 0.15 [.006] 04026 2-192042-4
20	OBSOLETE	[.022]	--	B	[.14]	14	3.0 [.118] 10 UNPL 0.15 [.006] 04022 2-192042-3
20	OBSOLETE	[.022]	--	B	[.13]	14	2.8 [.110] 10 3-2 0.12 [.005] 04021 2-192042-2
20	OBSOLETE	[.022]	--	B	[.13]	14	2.5 [.098] 9 3-2 0.15 [.006] 04018 2-192042-1
20	OBSOLETE	[.026]	--	B	[.13]	14	2.3 [.091] 9 3-2 0.20 [.008] 04016 2-192042-0
20	OBSOLETE	[.022]	--	B	[.11]	14	2.0 [.080] 6 6 0.15 [.006] 04014 1-192042-9
20	OBSOLETE	[.022]	--		[.11]	14	2.0 [.080] 6 3-2 0.15 [.006] 04012 1-192042-8
20	OBSOLETE	[.026]	--	B	[.11]	14	2.0 [.080] 6 3-2 0.12 [.005] 04011 192042 -7
20	OBSOLETE	[.026]	--	B	[.11]	14	2.0 [.080] 6 3-2 0.15 [.006] 04152 1-192042-6
20	OBSOLETE	[.026]	--	B	[.11]	14	2.0 [.080] 6 6 0.12 [.005] 04171 1-192042-5
20	OBSOLETE	[.026]	--	B	[.11]	14	2.0 [.080] 6 UNPL 0.12 [.005] 04219 1-192042-4
20	OBSOLETE	[.020]	--	B	[.10]	14	2.0 [.080] 6 6 0.10 [.004] 04153 1-192042-3
20	OBSOLETE	[.020]	--	B	[.10]	14	2.0 [.080] 6 UNPL 0.10 [.004] 04150 1-192042-2
20	OBSOLETE	[.026]	NOTE 13	C	--	14	-- -- 3-2 0.12 [.005] 04151 1-192042-1
20	OBSOLETE	[.028]	NOTE 12	C	--	14	-- -- 3-2 0.20 [.008] 04175 1-192042-0
20	OBSOLETE	[.028]	NOTE 12	C	--	14	-- -- 1-2 0.20 [.008] 04127 192042-9
20	OBSOLETE	[.028]	NOTE 12	C	--	14	-- -- UNPL 0.20 [.008] 04160 192042-8
20	OBSOLETE	[.026]	NOTE 12	C	--	14	-- -- 3-2 0.15 [.006] 04161 192042-7
20	OBSOLETE	[.026]	NOTE 12	C	--	14	-- -- 1-2 0.15 [.006] 04003 192042-6
20	OBSOLETE	[.026]	NOTE 12	C	--	14	-- -- 1-2 0.15 [.006] 04217 192042-5
20	OBSOLETE	[.026]	NOTE 12	C	--	14	-- -- UNPL 0.15 [.006] 04085 192042-4
20	OBSOLETE	[.026]	NOTE 12	C	--	14	-- -- 1-2 0.12 [.005] 04141 192042-3
20	OBSOLETE	[.026]	NOTE 12	C	--	14	-- -- UNPL 0.12 [.005] -- 192042-2
20	OBSOLETE	[.016]	NOTE 12	C	--	15	-- -- UNPL 0.12 [.005] 04181 192042-1

LH	LENGTH	STYLE	(FREE DIA)	MAT'L NOTE	MATING HOLE φ REF	NUM LOUV	PLATING	MAT'L THK	REF	PART NO.
THIS DRAWING IS A CONTROLLED DOCUMENT.										
DIMENSIONS: mm					TOLERANCES UNLESS OTHERWISE SPECIFIED:		DWN RA JAYNE 06-12-92			
					0 PLC ± -		CHK J.TURNER 07-21-93			
					1 PLC ± -		APVD S.SIEGRIST 07-21-93			
					2 PLC ± 0.5[.02]		NAME CONTACT BAND, MALE			
					3 PLC ± 0.25[.010]		SIZE A2 CAGE CODE 00779 DRAWING NO C=192042			
					4 PLC ± -		RESTRICTED TO			
					ANGLES ± -		SCALE 1:1 SHEET 1 of 2 REV T			
MATERIAL					FINISH		CUSTOMER DRAWING			

