

1473252-1 ✓ ACTIVE

AMP | MQS

TE Internal #: 1473252-1

Housing for Female Terminals, Wire-to-Board / Wire-to-Device, 40 Position, .1 in / .311 in / .114 in [2.54 mm] Centerline, Sealable, Black, MQS

[View on TE.com >](#)



Connectors > Automotive Connectors > Automotive Housings > MQS, CONNECTOR HOUSING

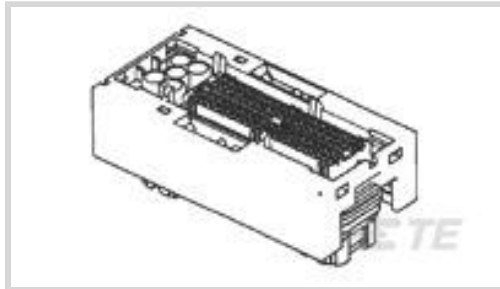

Connector & Housing Type: **Housing for Female Terminals**

Mating Tab Width: **.63 mm [.025 in, .11 in]**

Connector System: **Wire-to-Board, Wire-to-Device**

Number of Positions: **40**

Centerline (Pitch): **2.54 mm [.1 in, .114 in, .228 in, .311 in]**

[All MQS, CONNECTOR HOUSING \(558\)](#)

Features

Product Type Features

Connector Shape	Rectangular
Connector & Housing Type	Housing for Female Terminals
Connector System	Wire-to-Board, Wire-to-Device
Sealable	Yes
Hybrid Connector	Yes

Configuration Features

Number of Positions	40
Number of Rows	3, 4

Electrical Characteristics

Operating Voltage	12 VDC
Nominal Voltage Architecture	12 V

Body Features

Cable Exit Angle	90°
Primary Product Color	Black

Contact Features

Contact Size	.63mm, 2.8mm
--------------	--------------



Contact Type	Receptacle
Mating Tab Width	.63 mm[.025 in][.11 in]

Mechanical Attachment

Terminal Position Assurance	Yes
Strain Relief	Without
Mating Alignment Type	Polarized
Mating Alignment	With
Connector Mounting Type	Cable Mount (Free-Hanging)

Housing Features

Centerline (Pitch)	2.54 mm[.1 in][.114 in][.228 in][.311 in]
--------------------	---

Dimensions

Connector Height	31 mm[1.22 in]
Product Width	37.4 mm[1.472 in]
Product Length	54.3 mm[2.138 in]
Row-to-Row Spacing	4.4 mm[.173 in]

Usage Conditions

Operating Temperature (Max)	70 °C, 75 °C, 80 °C, 85 °C, 90 °C, 100 °C, 105 °C, 110 °C, 120 °C[158 °F][167 °F][176 °F][185 °F][194 °F][212 °F][221 °F][230 °F][248 °F]
Operating Temperature Range	-40 – 120 °C[-40 – 248 °F]

Operation/Application

Circuit Application	Signal
---------------------	--------

Industry Standards

UL Flammability Rating	UL 94HB
------------------------	---------

Packaging Features

Packaging Quantity	42
Packaging Method	Tray

Other

Serviceable	Yes
Connector Position Assurance Capable	No

Product Compliance



[For compliance documentation, visit the product page on TE.com>](#)

EU RoHS Directive 2011/65/EU	Compliant
EU ELV Directive 2000/53/EC	Compliant
China RoHS 2 Directive MIIT Order No 32, 2016	No Restricted Materials Above Threshold
EU REACH Regulation (EC) No. 1907/2006	Current ECHA Candidate List: JUNE 2022 (224) Candidate List Declared Against: JUNE 2022 (224) Does not contain REACH SVHC
Halogen Content	Low Halogen - Br, Cl, F, I < 900 ppm per homogenous material. Also BFR/CFR/PVC Free
Solder Process Capability	Not applicable for solder process capability

Product Compliance Disclaimer

This information is provided based on reasonable inquiry of our suppliers and represents our current actual knowledge based on the information they provided. This information is subject to change. The part numbers that TE has identified as EU RoHS compliant have a maximum concentration of 0.1% by weight in homogenous materials for lead, hexavalent chromium, mercury, PBB, PBDE, DBP, BBP, DEHP, DIBP, and 0.01% for cadmium, or qualify for an exemption to these limits as defined in the Annexes of Directive 2011/65/EU (RoHS2). Finished electrical and electronic equipment products will be CE marked as required by Directive 2011/65/EU. Components may not be CE marked. Additionally, the part numbers that TE has identified as EU ELV compliant have a maximum concentration of 0.1% by weight in homogenous materials for lead, hexavalent chromium, and mercury, and 0.01% for cadmium, or qualify for an exemption to these limits as defined in the Annexes of Directive 2000/53/EC (ELV). Regarding the REACH Regulation, the information TE provides on SVHC in articles for this part number is based on the latest European Chemicals Agency (ECHA) 'Guidance on requirements for substances in articles' posted at this URL: <https://echa.europa.eu/guidance-documents/guidance-on-reach>

Compatible Parts



TE Part # CAT-HPCH5372
HIGH PIN COUNT HEADER

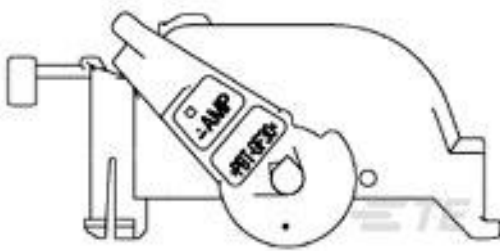

TE Part # 1473255-1
MQS 40P LEVER(L) ASSY



TE Part # 368388-1
MQS RETAINER HSG FOR 40P



TE Part # CAT-T4827-T273
TIMER, RECEPTACLE AND TAB



TE Part # 1473255-2
LEVER ASSY TYPE-A NO SLIT TYPE
40POS

Also in the Series | MQS



Automotive Connector Caps & Covers (133)



Automotive Connector EMC Shielding (2)

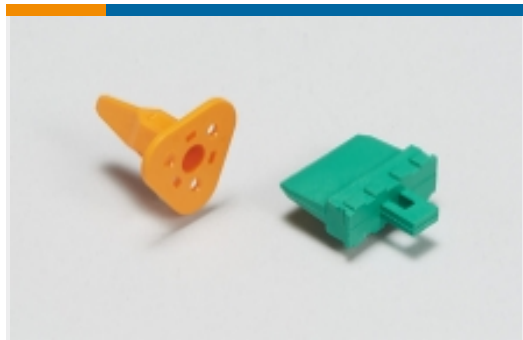

Automotive Connector Locks & Position Assurance(29)



Automotive Housings(492)



Automotive Seals & Cavity Plugs(26)



Automotive Terminals(96)



Insertion & Extraction Tools(42)



Other Automotive Connector Accessories(13)

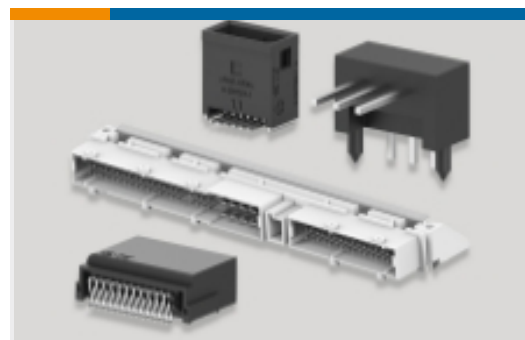

PCB Headers & Receptacles(209)

Customers Also Bought



TE Part #368388-1
MQS RETAINER HSG FOR 40P



TE Part #2209545-9
94P PLUG ASSY, NORMAL CODING



TE Part #1456471-4
8p Hybrid 0.64/2.8 Unsealed Plug Assy



TE Part #5-968220-1
MQS0,63 Sn rec CB unseal. 0,2-0,35



TE Part #2209544-9
60P,PLUG ASSY,NORMAL CODING

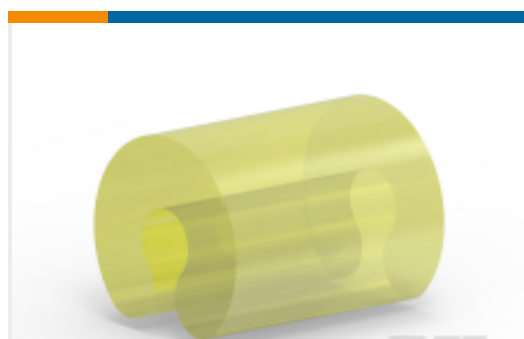

TE Part #7907156001
RBK-ESS-CLIP-1.5-X-8MM



TE Part #2137752-1
Lever for 154P ECU connector



TE Part #1-1418790-1
COVER,MQS,2X4POSN.

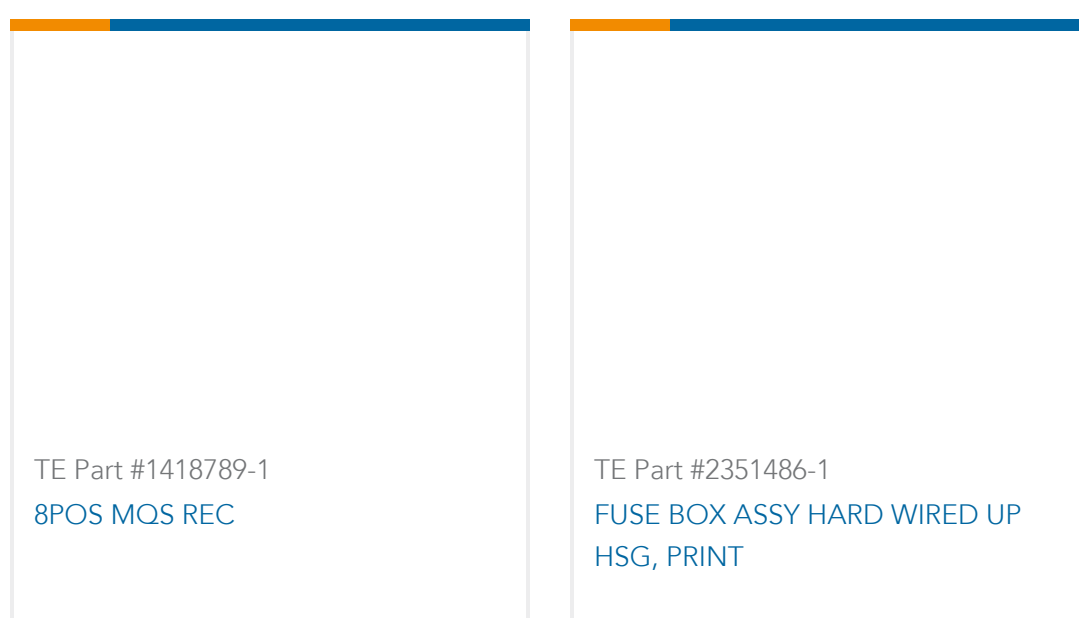

Documents

Product Drawings

[40POS MIXED MQS REC SEALED](#)

Japanese

CAD Files

Customer View Model

[ENG_CVM_1473252-1_A1.3d_igs.zip](#)

English

Customer View Model

[ENG_CVM_1473252-1_A1.3d_stp.zip](#)

English

Customer View Model

[ENG_CVM_1473252-1_A1.2d_dxf.zip](#)

English

[3D PDF](#)

English

By downloading the CAD file I accept and agree to the [Terms and Conditions](#) of use.

Datasheets & Catalog Pages

[Micro Quadlok Interconnection System \(MQS\)](#)

English

Product Specifications

[Application Specification](#)

English

Product Environmental Compliance

[Product Compliance](#)

English

[Product Compliance](#)

English

Instruction Sheets

[Instruction Sheet \(non U.S.\)](#)

English

[Instruction Sheet \(non U.S.\)](#)

1473252-1

Housing for Female Terminals, Wire-to-Board / Wire-to-Device, 40 Position, .1 in / .311 in / .114 in [2.54 mm] Centerline, Sealable, Black, MQS



Japanese