

U.I. Lapp GmbH	PRODUCT INFORMATION	
	SKINDICHT® SVFK	29.11.2013

Economical type
Lateral sealing lips fit automatically around various cable dimensions
Cable-specific seal dimensions are no longer necessary
Tolerance
Large opening allows clamping of up to two flat cables



Application range

For inserting flat cables.
Conveyor systems
Pumps
Lifts
Control cabinet manufacturing

Design

PG connection thread

Note

Counter nut to be used: SKINDICHT® GMK
For suitable flat cables, refer to ÖLFLEX® LIFT F for indoor applications or ÖLFLEX® CRANE F for outdoor applications

Remark

Photographs are not to scale and do not represent detailed images of the respective products.

Technical Data

Caution:	The installation dimensions can be found in appendix T21
Colour delivered:	Light grey (RAL 7035)
Material:	Body: Polystyrene Special sealing insert: CR
Protection rating:	IP 54
Temperature range:	-20°C to +60°C

Product Management	Document: LAPP_PRO1082EN.pdf	1 / 3
--------------------	------------------------------	-------



Part number	Article designation / size	Min./max. flat cable width	Min./max. cable thickness (mm)	SW1/SW2 mm	Overall length/ C (mm)	Thread length/ D (mm)
SKINDICHT® SVFK						
52005470	SVFK 16	-- 15	-- 5	27 / 23	39,5	10.0
52005680	SVFK 21	10 - 20,5	3 - 8	32 / 30	43.0	11.0
52005690	SVFK 29	15 - 27	4 - 11,5	42 / 41	45.0	11.0
52005700	SVFK 36	25 - 34	4 - 11,5	53 / 50	51.0	13.0
52005710	SVFK 42	30 - 40	5 - 12	60 / 55	54.0	13.0
52005720	SVFK 48	35 - 45	5 - 12	65 / 60	55.0	15.0

U.I. Lapp GmbH	PRODUCT INFORMATION	
	SKINDICHT® SVFK	29.11.2013

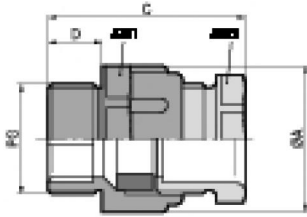

Product Management	Document: LAPP_PRO1082EN.pdf	3 / 3
--------------------	------------------------------	-------