

U.I. Lapp GmbH	DATASHEET	 LAPP GROUP
	EPIC® H-A 3 Hood Metal straight entry	19426500 12.09.2012

Innovative metal and plastic housing design
Housing in plastic or metal version. For power supply in the smallest possible space



Application range

Machine and equipment manufacturing
Control engineering
Electronic laboratory

Product features

Hood
Bolts for single lever
Straight cable entry
Versions with / without cable gland

Remark

Photographs are not to scale and do not represent detailed images of the respective products.

Technical Data

Pieces / PU:	10
Dimensions incl. cable gland:	57
Cable clamping range:	3 - 13,5
Cable gland:	yes
Colour:	grey
Material:	Zinc die-casting
M:	20
Article:	H-A 3 MTgv M20
Material:	Housing: powder-coated zinc die-casting, grey Lever: zinc-plated steel
Protection rating:	IP 65 (latched)
Temperature range:	-40 °C to +100 °C, short-term up to +125 °C



Product Management	Document: EPIC® H-A 3 Hood Metal straight entry	1 / 2
--------------------	---	-------

U.I. Lapp GmbH	DATASHEET	 LAPP GROUP
	EPIC® H-A 3 Hood Metal straight entry	19426500 12.09.2012

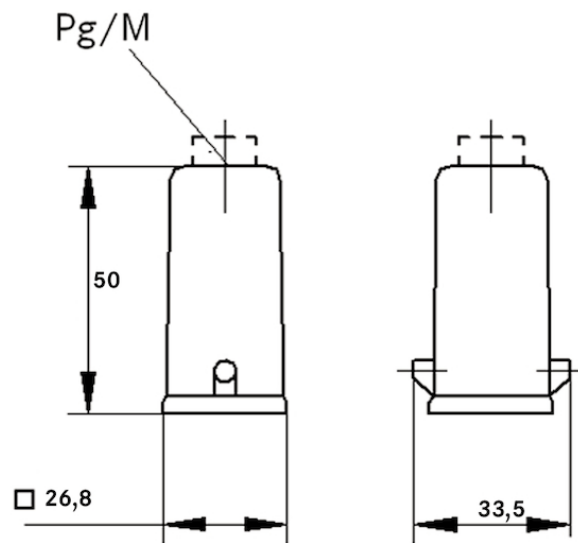

Product Management	Document: EPIC® H-A 3 Hood Metal straight entry	2 / 2
--------------------	---	-------