

2J9C34JW-C392N

IRIDIUM/GPS Pole Mount

Key Features

GPS/QZSS/Galileo and IRIDIUM

- 1575 MHz
- 1616-1627 MHz

Iridium Certified

Pole Mount

High Performance

Single Feed Technology

Ground Plane Independent

Integrated TNC Female

Dimensions Ø 74 × 116 mm

Certificates: IP67



1. Antenna and electrical specifications

Cable 1

Parameters	GNSS and IRIDIUM Antenna	
	GPS/QZSS/Galileo	IRIDIUM
Standards		
Bands (MHz)	1575	1621
Frequency (MHz)	1575.42	1616 - 1627
Return Loss (dB)	~-27.6	~-21.6
VSWR	~1.1:1	~1.3:1
Efficiency (%)	~93.8	~92.9
Peak Gain (dBi)	~5.1	~5.7
Average Gain (dB)	~-0.3	~-0.3
Impedance (Ohms)	50	
Axial Ratio (dB)	3 max	
Radiation Pattern	Hemispherical	
Polarization	RHCP	
Connector Type	TNC-Female	

Antenna Measurement Conditions:

Free Space

Measured in Certified CTIA 3D Anechoic Chamber

2. Mechanical and environmental specifications

Specifications	2J9C34JW-C392N
Mounting Type	Pole Mount
Thread	1"-14 TPI
Dimensions (mm)	Ø 74 × 116
Radome Type	ABS
Radome Color	White
Operating Temperature (C)	-40 to +85
Storage Temperature (C)	-40 to +85
Certificates	IP67

3. Antenna parameters

IRIDIUM/GPS

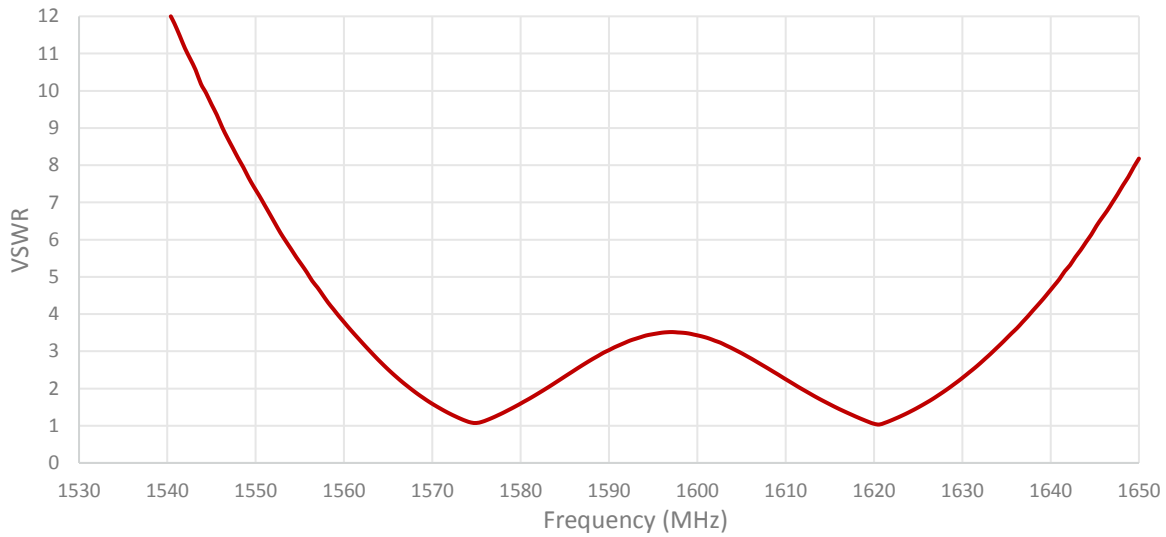
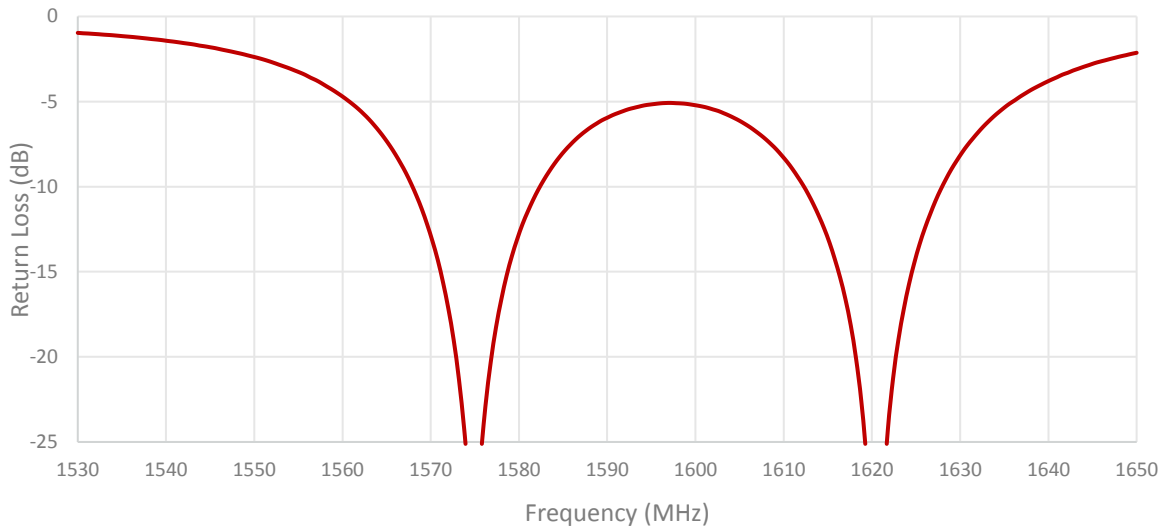

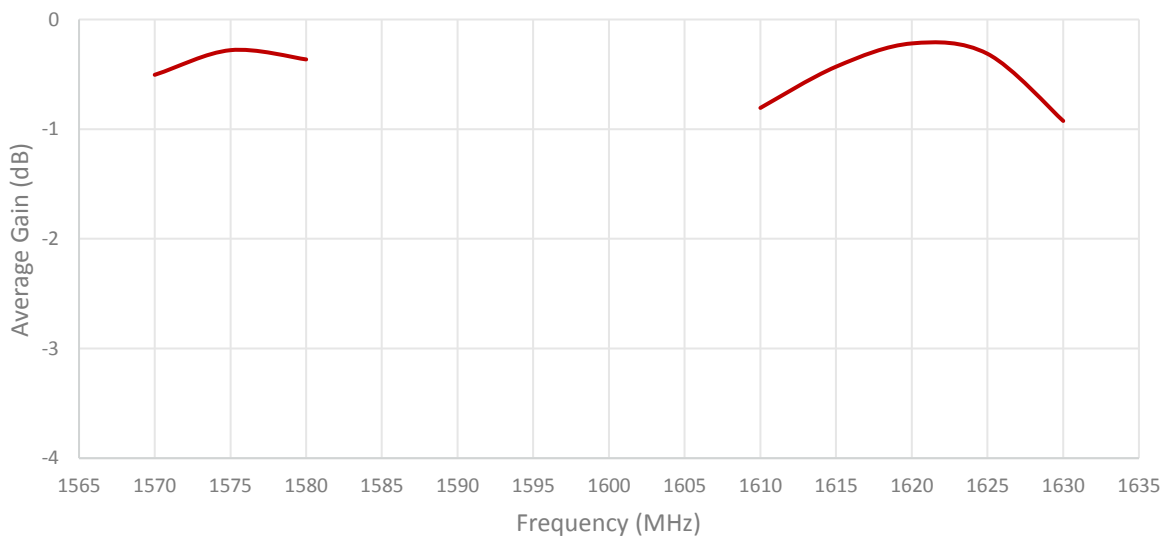
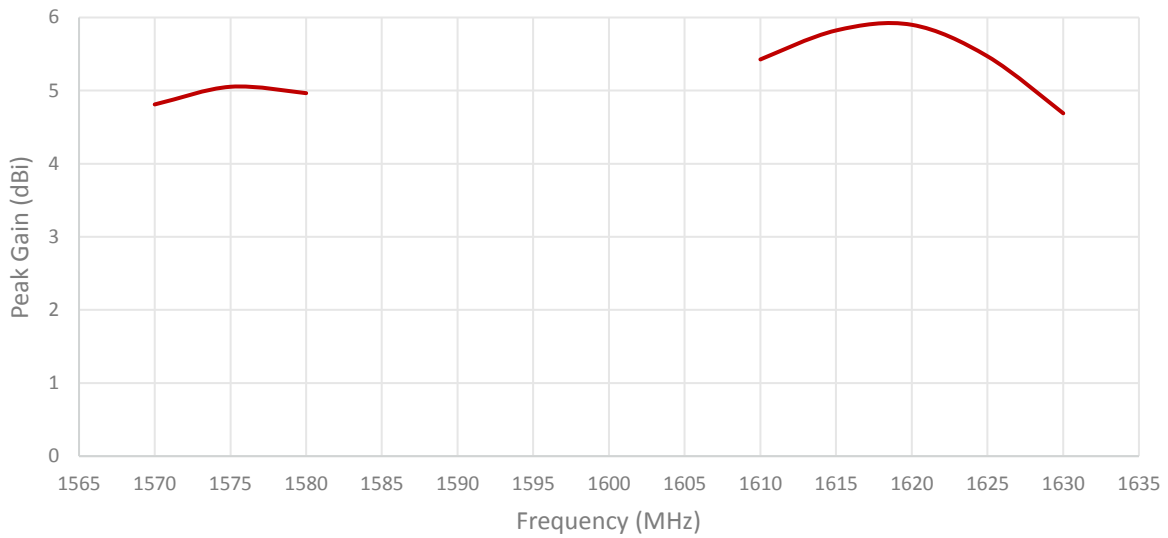
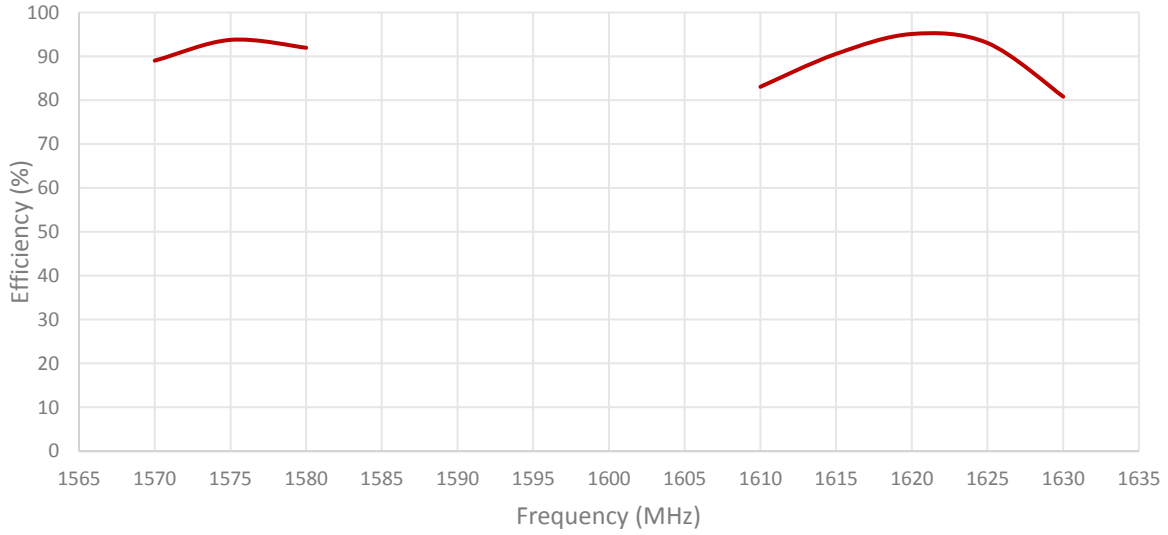

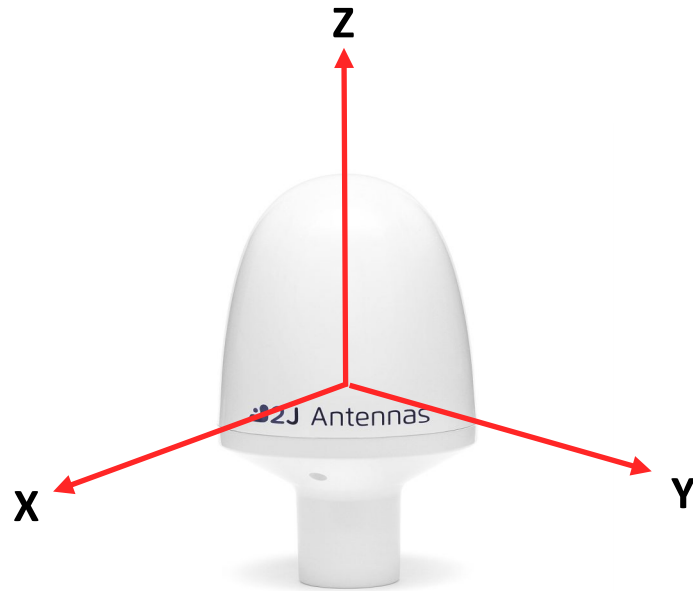

Radiation pattern reference

IRIDIUM/GPS

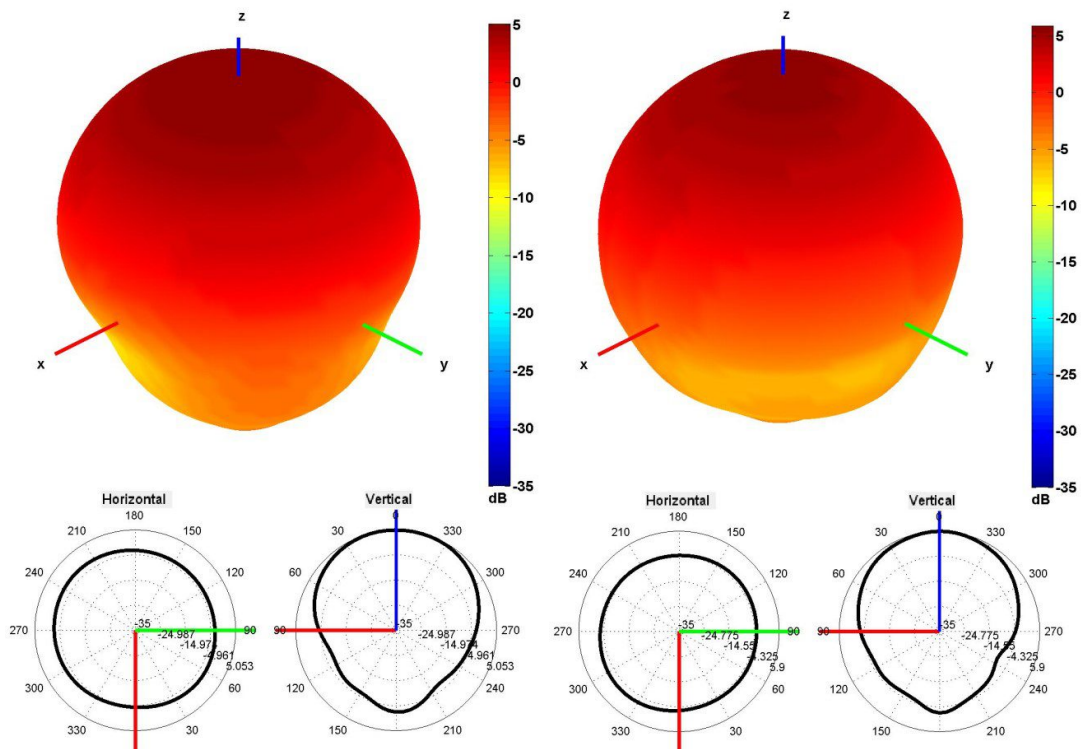

1575 and 1621 MHz Radiation pattern

4. Antenna drawings

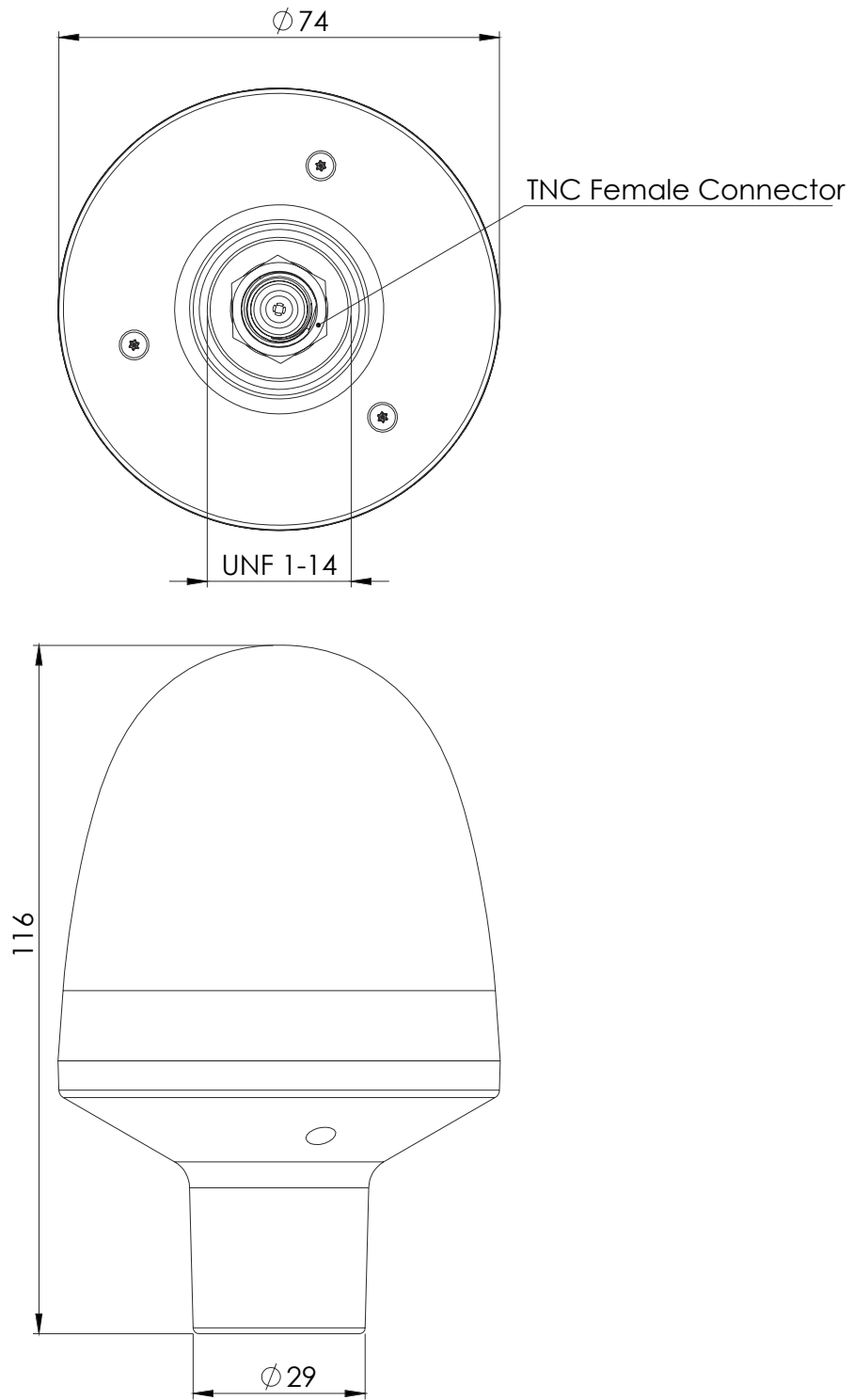

5. Antenna Images

