

Flush-type socket - SACC-DSI-FSX-8CON-PG9-L180 SCO - 1404741

Please be informed that the data shown in this PDF Document is generated from our Online Catalog. Please find the complete data in the user's documentation. Our General Terms of Use for Downloads are valid (<http://phoenixcontact.com/download>)



CAT6_A flush-type socket, Ethernet, one-piece, 8-pos., M12-SPEEDCON, rear/screw mounting with Pg9 fastening thread, with straight solder connection

M12 panel feed-through, rear mounting



Key Commercial Data

Packing unit	20 pc
GTIN	 4 046356 737029
Weight per Piece (excluding packing)	15.66 g
Custom tariff number	85366990
Country of origin	Germany

Technical data

Ambient conditions

Degree of protection	IP67 (When plugged in)
----------------------	------------------------

General data

Rated current at 40°C	0.5 A (Data)
Rated voltage	50 V AC 60 V DC
Number of positions	8
Signal type/category	Ethernet CAT6 _A
Standards/regulations	M12 connector IEC 61076-2-109
Overvoltage category	III
Pollution degree	3

Flush-type socket - SACC-DSI-FSX-8CON-PG9-L180 SCO - 1404741

Classifications

eCl@ss

eCl@ss 4.0	272607xx
eCl@ss 4.1	27260701
eCl@ss 5.0	27260701
eCl@ss 5.1	27260701
eCl@ss 6.0	27180802
eCl@ss 7.0	27182702
eCl@ss 8.0	27440103

ETIM

ETIM 3.0	EC001031
ETIM 4.0	EC002498
ETIM 5.0	EC002061

UNSPSC

UNSPSC 6.01	31261501
UNSPSC 7.0901	31261501
UNSPSC 11	31261501
UNSPSC 12.01	31261501
UNSPSC 13.2	31261501

Approvals

Approvals

Approvals

EAC / EAC

Ex Approvals

Approvals submitted

Approval details

EAC

EAC

Drawings

Flush-type socket - SACC-DSI-FSX-8CON-PG9-L180 SCO - 1404741

Dimensional drawing

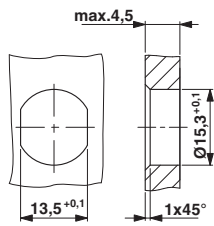

Schematic diagram

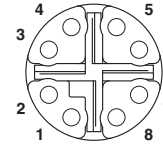

M12 socket pin assignment, 8-pos, view of socket side

Housing cutout for Pg9 fastening thread, mounting panel with feed-through hole (alternatively with surface as protection against rotation)

Drilling diagram

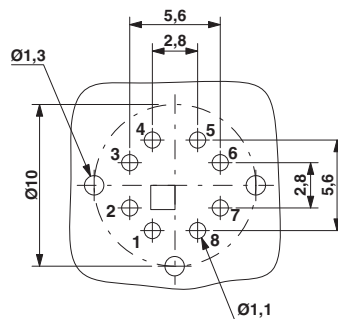

Soldering pad geometry