

IEC Appliance Inlet C16, Screw-on Mounting, Front or Rear Side, Solder or Quick-connect Terminal



6110-3

C16  
  
 120° C



### Description

- Panel Mount:  
Screw-on mounting from front or rear-side
- Appliance Inlet, Pin temperature 120 °C, Protection class I
- Solder terminals or quick connect terminals

### Approvals

- VDE License Number: 40015595
- UL License Number: E96454

### Other versions on request

- Types for rivet mounting available upon request
- Sealing (IP54) of appliance and power input
- Types for enhanced glow wire test requirements acc. IEC 60695-2-11 to -13 for the use in unattended household equipment acc. IEC 60335-1

### References

[General Product Information](#)

### Weblinks

[Approvals](#), [RoHS](#), [CHINA-RoHS](#), [Mating Connectors](#), [e-Store](#), [SCHURTER-Stock-Check](#), [Distributor-Stock-Check](#)

### Technical Data

Ratings IEC	10A / 250VAC; 50Hz
Ratings UL/CSA	15A / 250VAC; 60Hz
Dielectric Strength	> 2 kVAC between L-N > 2 kVAC between L/N-PE (1 min/50Hz)
Allowable Operation Temp.	-25 °C to 120 °C
Degree of Protection	from front side IP 40 acc. to IEC 60529
Protection Class	Suitable for appliances with protection class 1 acc. to IEC 61140
Terminal	Solder terminals or quick connect terminals
Panel Thickness s	Screw: max 8 mm Mounting screw torque max 0.5 Nm
Material: Housing	Thermoplastic, black, UL 94V-0

Appliance Inlet	C16 acc. to IEC/EN 60320-1, UL 498, CSA C22.2 no. 42 (for hot conditions) pin-temperature 120 °C, 10A, Protection Class 1
-----------------	---

### Dimensions

6110-3

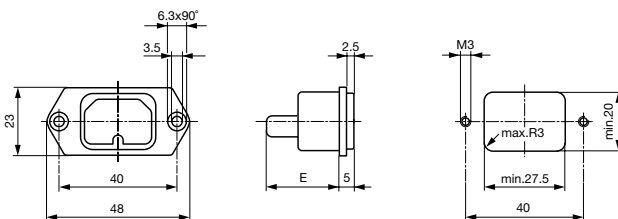
 48 mm

E: Solder terminals 20.5 mm  
 E: Quick connect terminals 23.5 mm

[Distributor-Stock-Check](#) | [SCHURTER-Stock-Check](#) | [e-Store](#)

## Variants

Type	Panel mounting	Panel Thickness s [mm]	Terminal	Order Number
6110-3	Screw	-	-	6110.3200
6110-3	Screw	-	Quick connect terminals 6.3 x 0.8 mm	6110.3300
6110-3	Screw	-	Solder terminals 3.8 x 0.8 mm	6110.3100

Option with IP54 sealing protects from entering fluids and dust into the appliance and the power input. This option can be ordered with ending ".30" (61xx.xxxx.30).

The sealing to the appliance on its own (no protection of power input) is available as accessory (sealing kit).

Articles for enhanced glow wire test requirements acc. IEC 60695-2-11 to -13 can be ordered with ending ".15" (xxxx.xxxx.15). They are suitable for the use in unattended household equipment acc. IEC 60335-1.

## Packaging unit

50 Pcs

## Accessories

## Description



[Sealing Kit](#)  
Sealing for Appliance Inlets

IP 54

0098.0103



[Cord retaining kits](#)  
Cord retaining strain relief

Flat head, A

4700.0001

## Mating Outlets/Connectors

## Category / Description

[Connector Overview complete](#)

IEC Connector C15, Rewireable, Straight

0101

IEC Connector C15A, Rewireable, Straight

0102

IEC Connector C15A, Rewireable, Straight

0102-G

IEC Connector C15A, Rewireable, Angled

0112

IEC Connector C15, Rewireable, Straight

4781

[Connector further types to 6110-3](#)

...

[Power Cord Overview complete](#)

Power Cord with IEC Connector C15, Straight, 120°C

3366

Power Cord with IEC Connector C15, Angled, 120°C

3368

[Power Cord further types to 6110-3](#)