

U.I. Lapp GmbH	<b>PRODUCT INFORMATION</b>	
	<b>EPIC® H-A 3 Hood Metal straight entry</b>	<b>12.09.2012</b>

Innovative metal and plastic housing design  
Housing in plastic or metal version. For power supply in the smallest possible space



#### Application range

Machine and equipment manufacturing  
Control engineering  
Electronic laboratory

#### Product features

Hood  
Bolts for single lever  
Straight cable entry  
Versions with / without cable gland

#### Remark

Photographs are not to scale and do not represent detailed images of the respective products.

#### Technical Data

Material:

Housing: powder-coated zinc die-casting, grey  
Lever: zinc-plated steel

Protection rating:

IP 65 (latched)

Temperature range:

-40 °C to +100 °C, short-term up to +125 °C



Product Management	Document: LAPP_PRO125868EN.pdf	1 / 3
--------------------	--------------------------------	-------

Part number	Article	M	PG	Material	Colour	Cable gland	Cable clamping range	Dimensions incl. cable gland
H-A housing: hood (straight cable entry)								
10512100	H-A 3 MTgv		11	Zinc die-casting	grey			
10426500	H-A 3 MTgv		11	Zinc die-casting	grey	yes	6,5 - 12	57
19512100	H-A 3 MTgv M20	20		Zinc die-casting	grey			
19426500	H-A 3 MTgv M20	20		Zinc die-casting	grey	yes	3 - 13,5	57

U.I. Lapp GmbH	<b>PRODUCT INFORMATION</b>	 <b>LAPP GROUP</b>
	<b>EPIC® H-A 3 Hood Metal straight entry</b>	12.09.2012

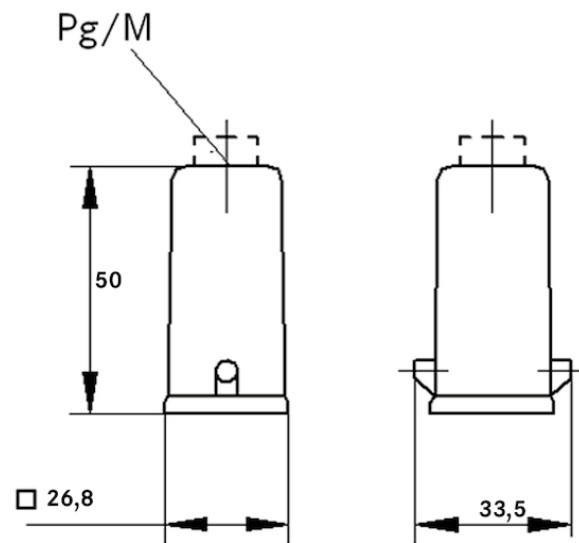

Product Management	Document: LAPP_PRO125868EN.pdf	3 / 3
--------------------	--------------------------------	-------